

**PROJECT DESCRIPTION:**

CONDUCT PERIODIC MAINTENANCE REPAIR WORK ON EXISTING RESIDENTIAL DOCK ON LAKE WASHINGTON. EXISTING WOODEN DECKING TO BE REPLACED WITH THRUFLOW GRATED PANELS. SOME FRAMING MEMBERS TO BE REPLACED (LESS THAN 50% OF EXISTING). SOME EXISTING PILES TO BE SLEEVED WITH HDPE TUBES AS SHOWN. (NO MORE THAN 50% OF EXISTING PILES TO BE SLEEVED). THREE EXISTING PILES TO BE REMOVED AS SHOWN.

**PROPERTY OWNER:**

ANITA CHUCK  
8920 N. MERCER WAY  
MERCER ISLAND, WA 98040

**CONTACT:**

IRWIN LAND USE CONSULTING, LLC  
P.O. BOX 1715  
BELLINGHAM, WA 98227  
(360) 410-6745  
irwinlanduse@gmail.com

**LEGAL DESCRIPTION:**

SUNNYBANK ADD SELY 1/2 OF 17& NWLY 25 FT OF 18 & SH LDS ADJ

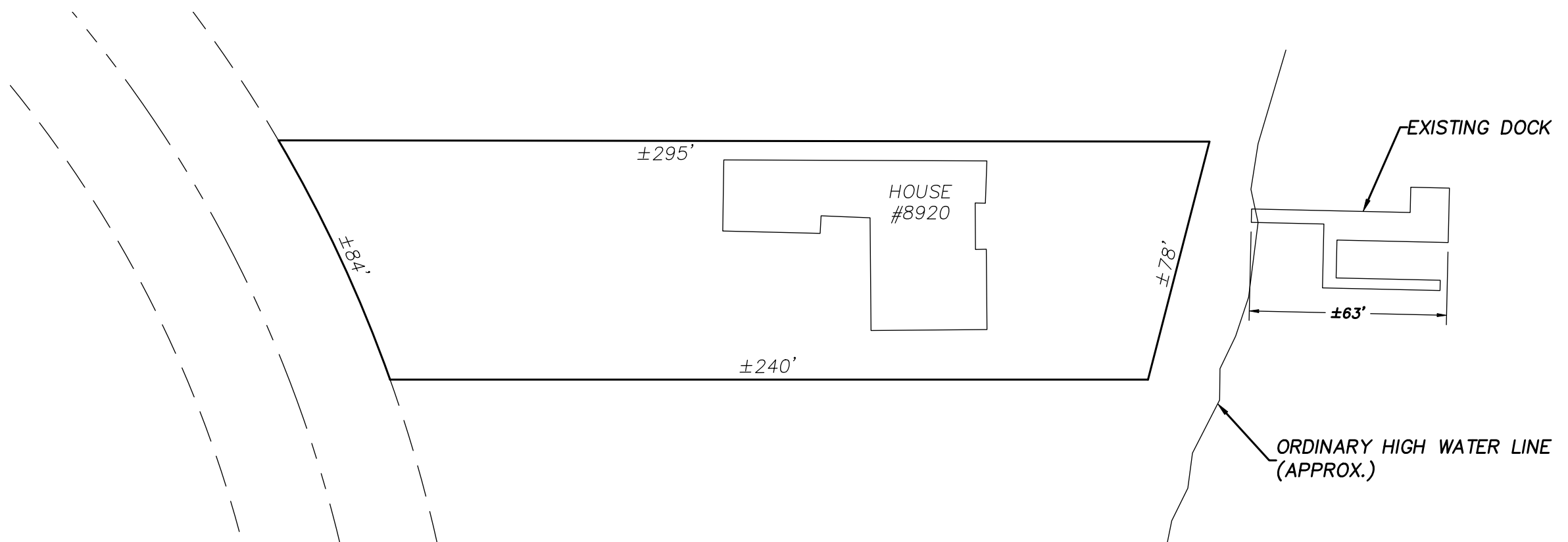
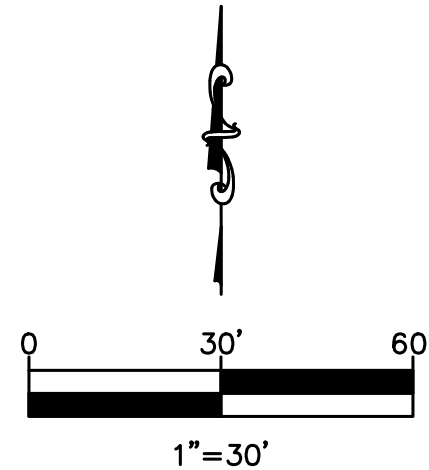
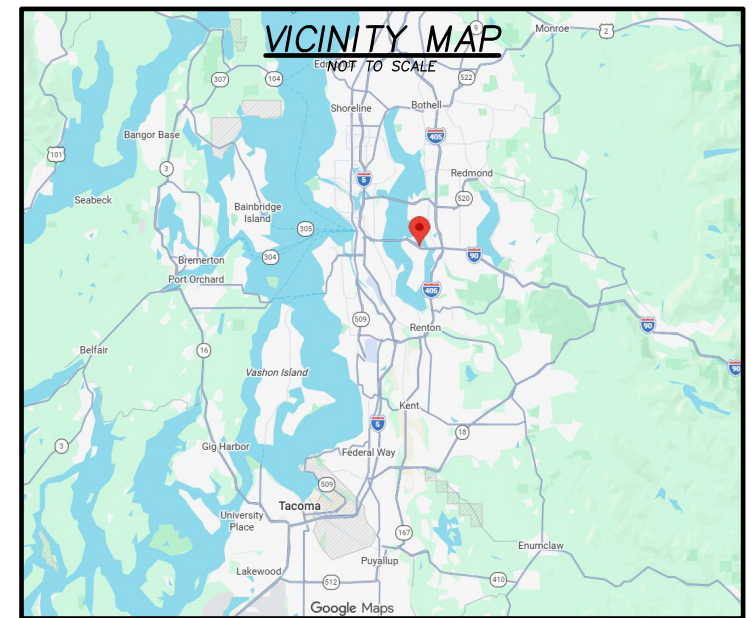

\*LOT BOUNDARIES AND BUILDING LOCATIONS PER DEED AFN 20050427001550 AND KING COUNTY ASSESSOR'S INFORMATION. DOCK DIMENSIONS, PROJECT DESCRIPTION AND WATER DEPTHS PER LAKESIDE CONSTRUCTION.



LAKESIDE CONSTRUCTION  
P.O. BOX 525  
ISSAQUAH, WA 98027  
(206) 850-0250  
sales@lakesideseattle.com

| REV | DATE | BY | DESCRIPTION |
|-----|------|----|-------------|
|     |      |    |             |
|     |      |    |             |
|     |      |    |             |
|     |      |    |             |

**CHUCK**  
**DOCK REPAIR**  
8920 N. MERCER WAY  
MERCER ISLAND, WA 98040

|                 |            |
|-----------------|------------|
| PROJECT NUMBER: | 2604       |
| PARCEL NUMBER:  | 8106100171 |
| ISSUE DATE:     | 3/25/2026  |

**DOCK LAYOUT**  
SCALE: 1"=10'

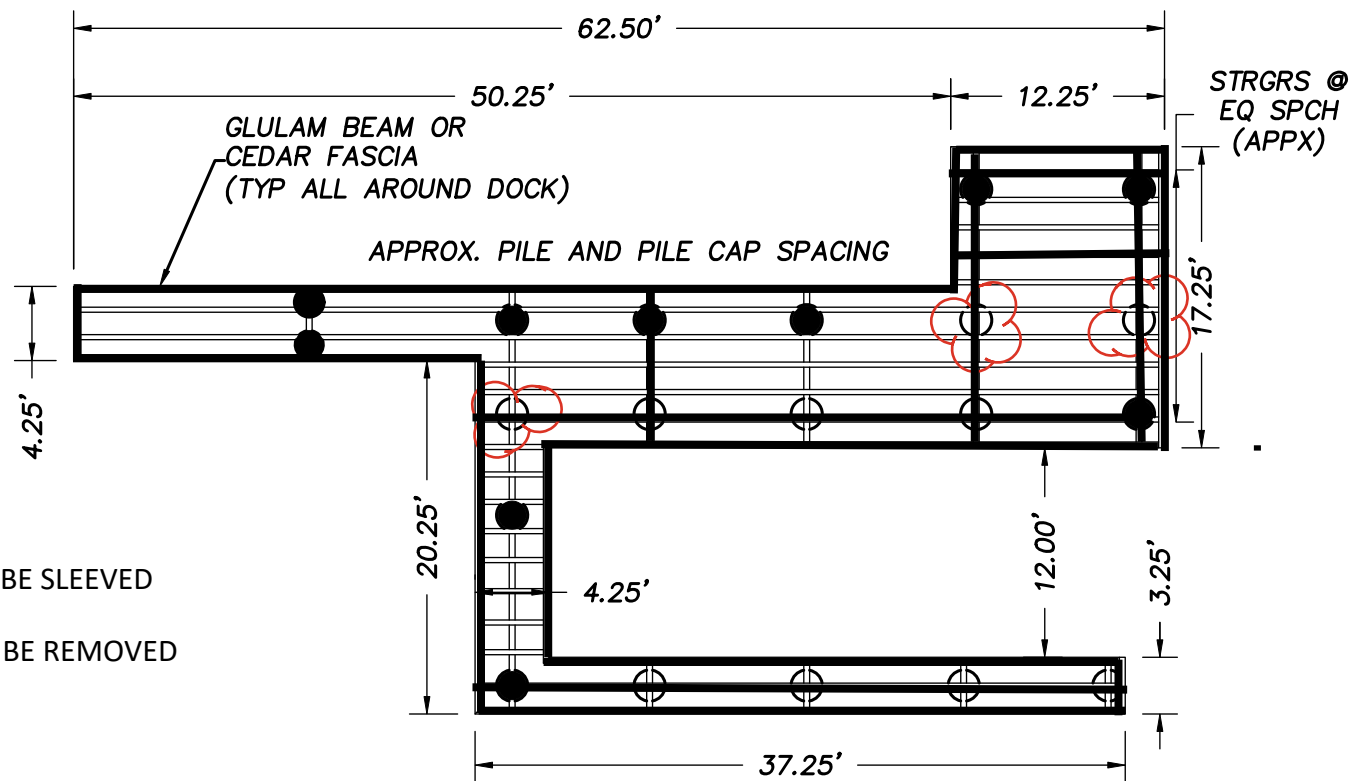

- = EXISTING PILES TO BE SLEEVED
- = EXISTING PILES TO BE REMOVED

**DOCK PROFILE**  
SCALE: 1"=10'

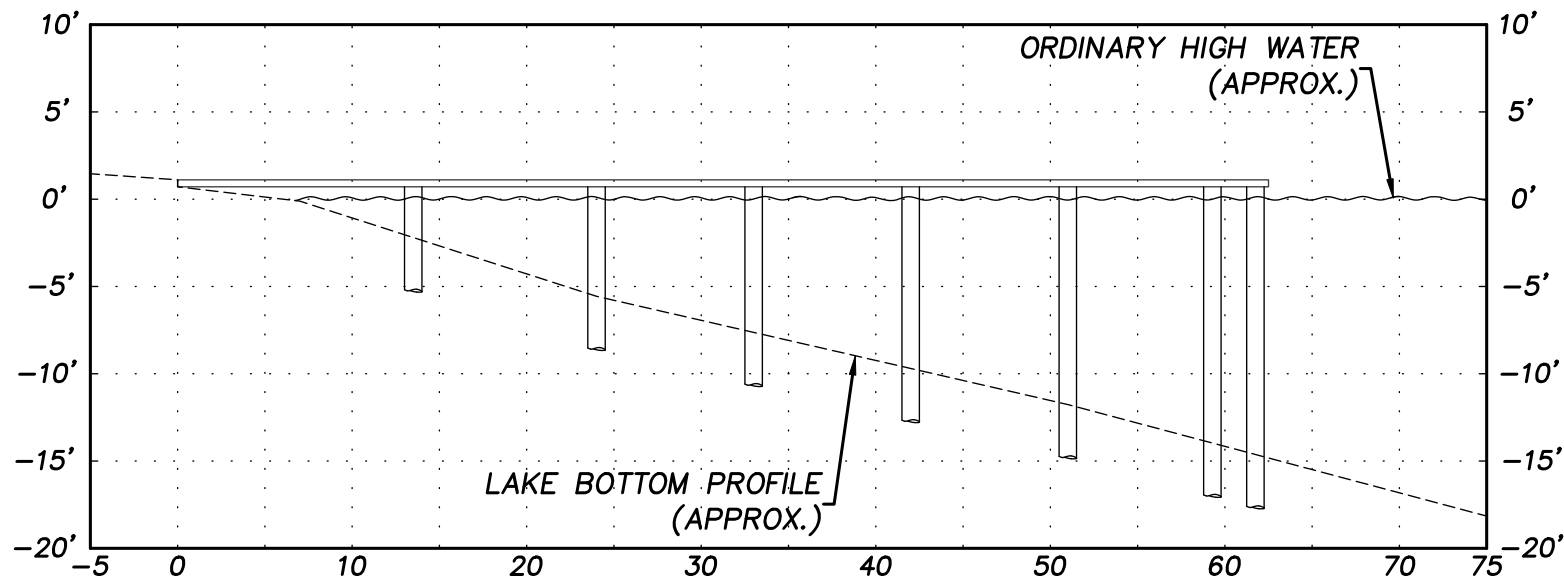

ALTERNATING 1/2"x16" GALV. THRU-BOLTS AND 1/4"x12" EPOXY TIMBER LOCKS

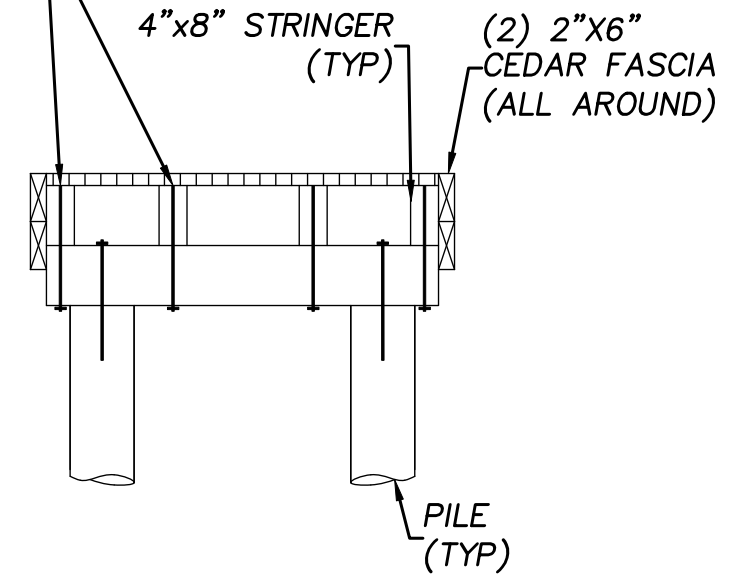

**PIER END SECTION**  
NTS

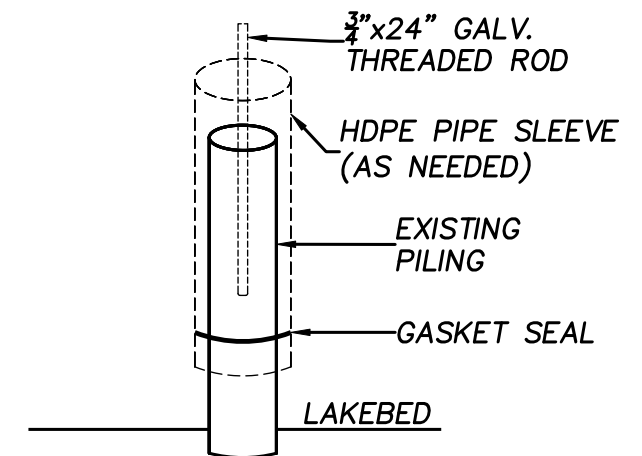

**PILE SLEEVING DETAIL**  
NTS



**LAKESIDE CONSTRUCTION**  
P.O. BOX 525  
ISSAQUAH, WA 98027  
(206) 850-0250  
sales@lakesideseattle.com

| REV | DATE | BY | DESCRIPTION |
|-----|------|----|-------------|
|     |      |    |             |
|     |      |    |             |
|     |      |    |             |
|     |      |    |             |

**CHUCK**  
**DOCK REPAIR**  
8920 N. MERCER WAY  
MERCER ISLAND, WA 98040

|                 |            |
|-----------------|------------|
| PROJECT NUMBER: | 2604       |
| PARCEL NUMBER:  | 8106100171 |
| ISSUE DATE:     | 3/25/2026  |