

PROJECT DESCRIPTION:

CONDUCT PERIODIC MAINTENANCE/REPAIR WORK ON EXISTING RESIDENTIAL DOCK ON LAKE WASHINGTON. WORN WOODEN DECKING TO BE REPLACED WITH THRUFLOW GRATED PANELS. WORN DOCK FRAMING ELEMENTS TO BE REPLACED AS SHOWN.

LEGAL DESCRIPTION:

SUNNYBANK ADD & SH LDS

PROPERTY OWNER:

CARL BIANCO
8700 N. MERCER WAY
MERCER ISLAND, WA 98040

CONTACT:

IRWIN LAND USE CONSULTING, LLC
P.O. BOX 1715
BELLINGHAM, WA 98227
(360) 410-6745
irwinlanduse@gmail.com

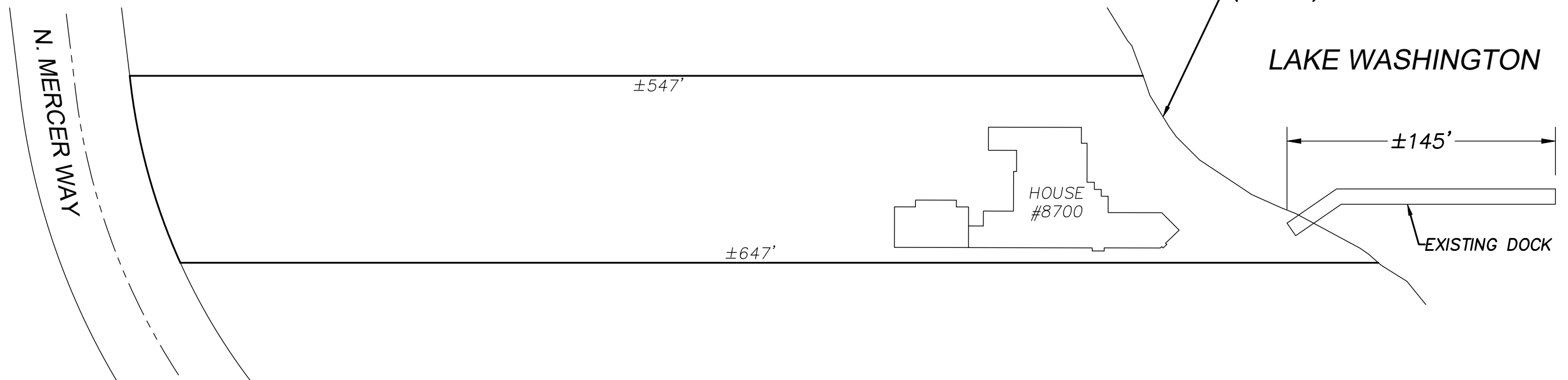
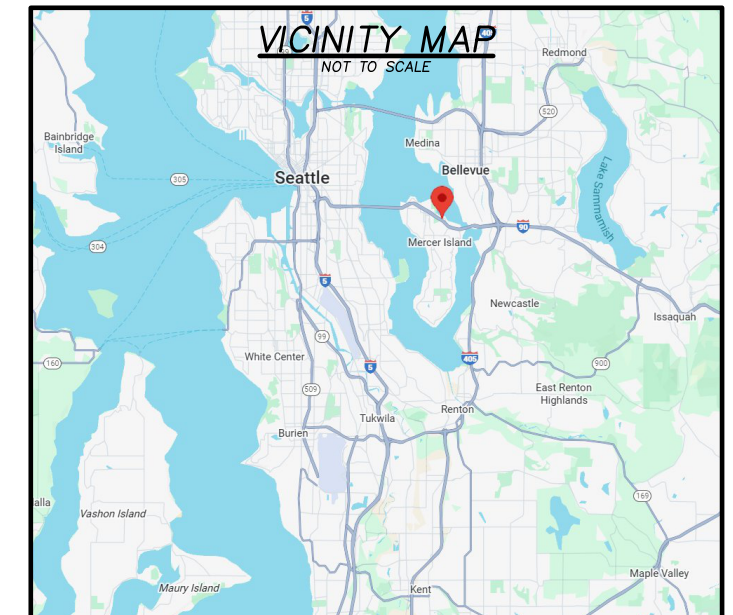
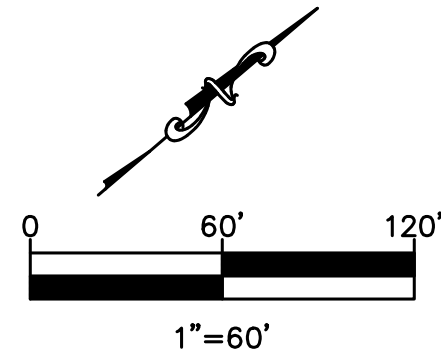

*LOT BOUNDARIES AND BUILDING LOCATIONS PER DODDS ENGINEERING SURVEY 6/94 AND KING COUNTY ASSESSOR'S GIS DATA. DOCK DIMENSIONS, PROJECT DESCRIPTION AND WATER DEPTHS PER LAKESIDE CONSTRUCTION.



LAKESIDE CONSTRUCTION
P.O. BOX 525
ISSAQUAH, WA 98027
(206) 850-0250
sales@lakesideseattle.com

REV	DATE	BY	DESCRIPTION

BIANCO
DOCK REPAIR
8700 N. MERCER WAY
MERCER ISLAND, WA 98040

PROJECT NUMBER:	2541
PARCEL NUMBER:	8106100120
ISSUE DATE:	1/5/2026

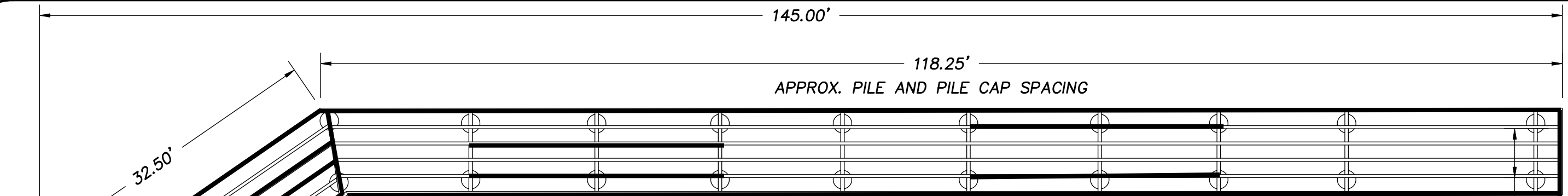

DOCK LAYOUT
SCALE: 1"=10'

FRAMING REPLACEMENT CALCULATIONS

TOTAL LINEAR FOOTAGE OF FRAMING COMPONENTS: 995

TOTAL LINEAR FEET OF FRAMING TO BE REPAIRED/REPLACED: 474

PERCENTAGE OF FRAMING TO BE REPLACED = 48%

GLULAM BEAM OR
CEDAR FASCIA
TYP ALL AROUND DOCK)

STRGRS @
EQ SPCH
(APPX)

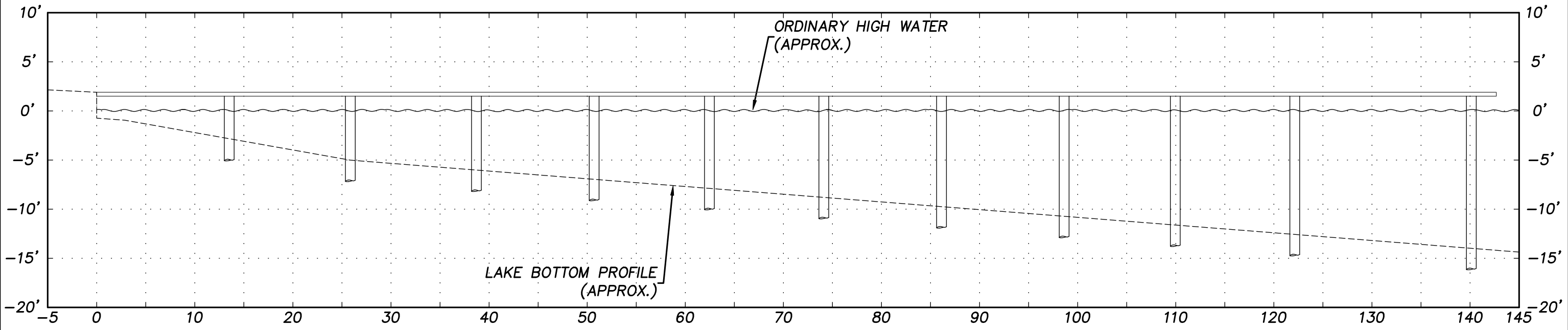

DOCK PROFILE
SCALE: 1"=10'



LAKESIDE CONSTRUCTION
P.O. BOX 525
ISSAQUAH, WA 98027
(206) 850-0250
sales@lakesideseattle.com

REV	DATE	BY	DESCRIPTION

BIANCO
DOCK REPAIR
8700 N. MERCER WAY
MERCER ISLAND, WA 98040

PROJECT NUMBER:	2541
PARCEL NUMBER:	8106100120
ISSUE DATE:	1/5/2026

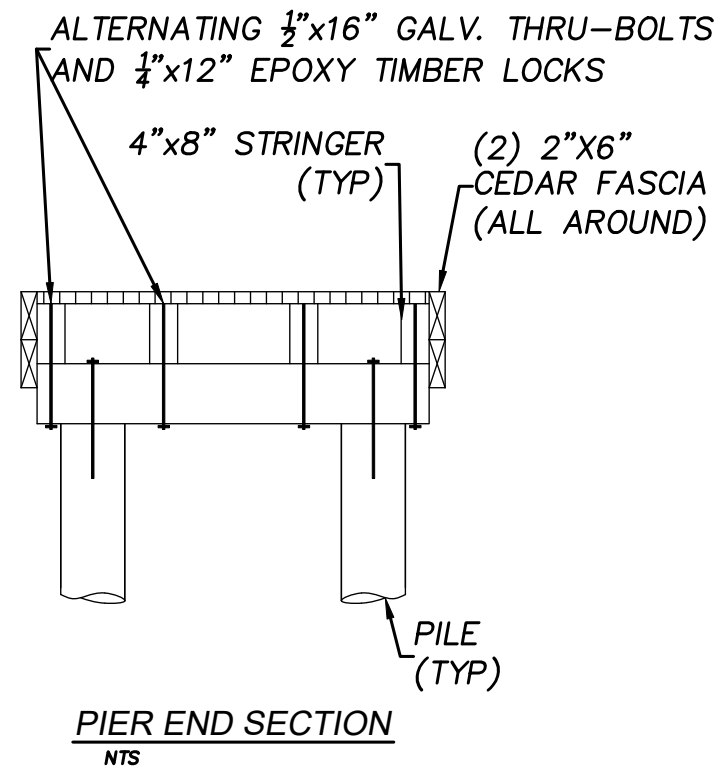

LAKESIDE CONSTRUCTION
P.O. BOX 525
ISSAQUAH, WA 98027
(206) 850-0250
sales@lakesideseattle.com

REV	DATE	BY	DESCRIPTION

BIANCO
DOCK REPAIR
8700 N. MERCER WAY
MERCER ISLAND, WA 98040

PROJECT NUMBER:	2541
PARCEL NUMBER:	8106100120
ISSUE DATE:	1/5/2026