

# SITE PLAN

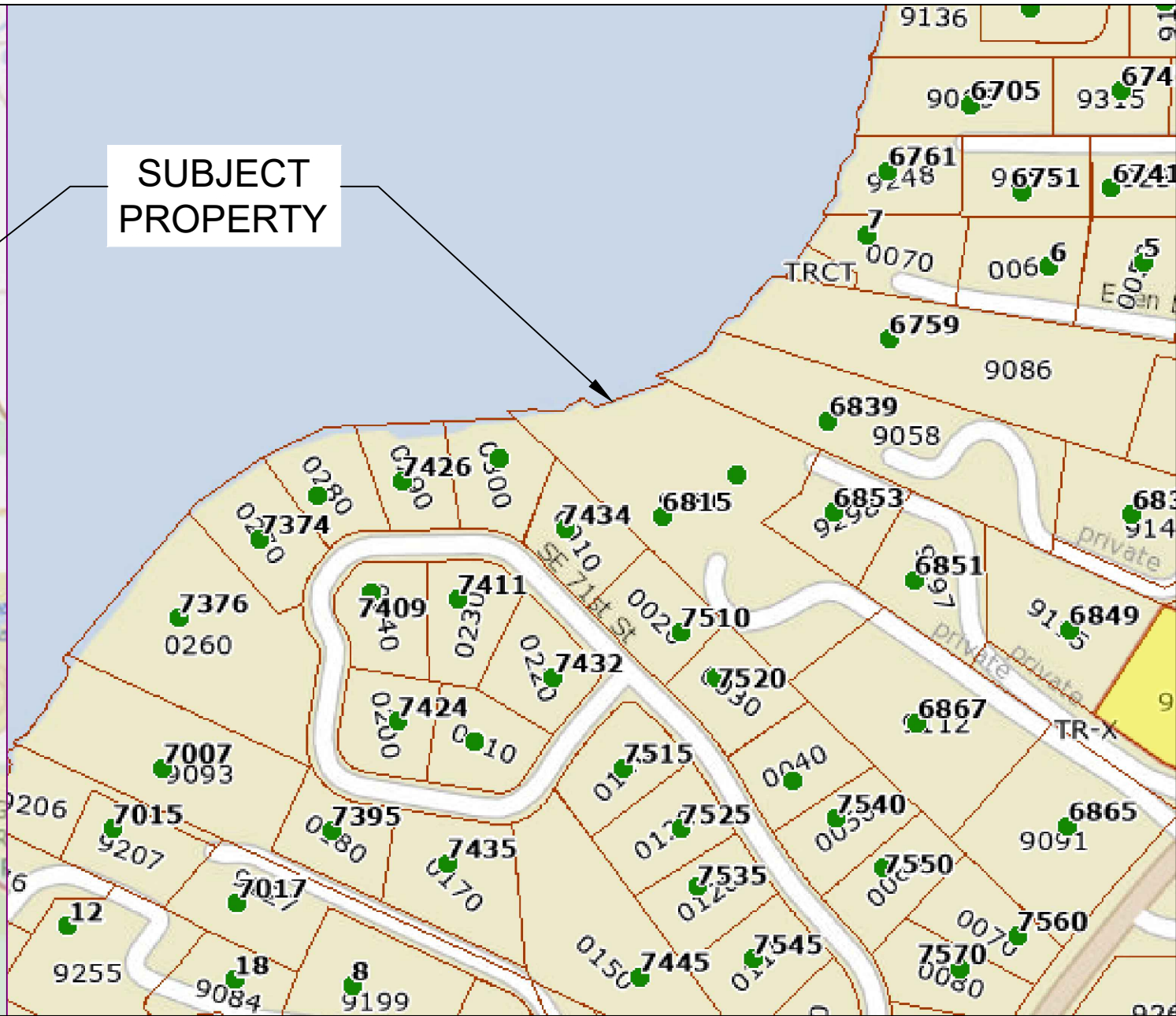
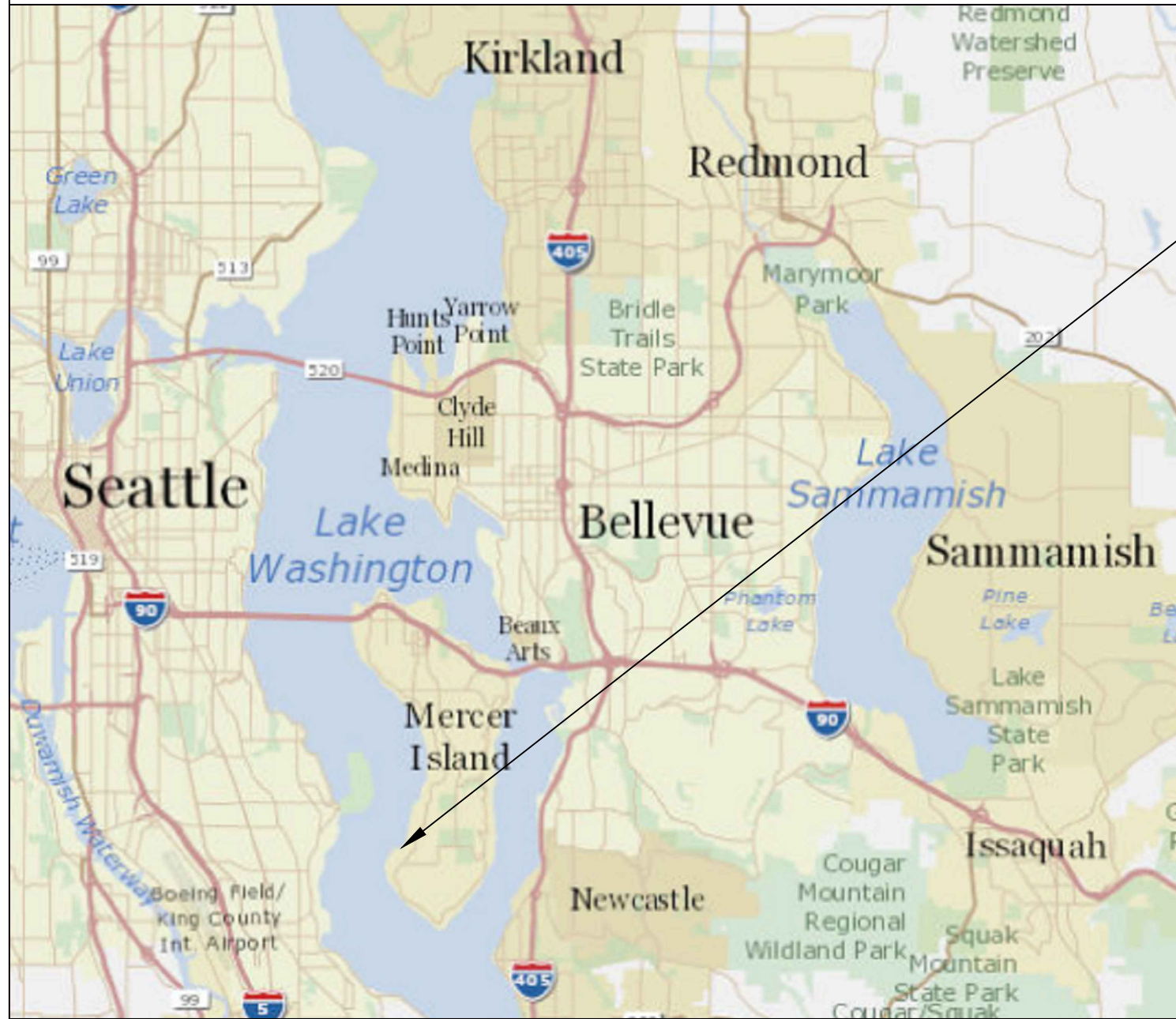

Pin: 252404-9080

Legal Description: CONSOLIDATED LOT PER MERCER ISLAND LOT CONSOLIDATION # MI SUB 09-004 REC# 20091202900012 SD LOT DAF- LOT C-3 TGW UND INT IN TR X MI SP #85-06-16 REC #8511139001 TGW LOTS A & B MI SP #MI-79-03-08 REC #7911130595 BEING POR N 1/2 GLS 2 & 3 & S 1/4 OF GL 1 LY W OF MERCER WAY & NELY OF MCLEAN ADD TGW SH LDS ADJ BUILDING 1

Plat Block:  
Plat Lot:

Parcel LAT: 47.54166 LONG: -122.23839  
Dock LAT: 47.541999 LONG: -122.239380

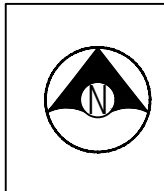

Seaborn Pile Driving  
1080 W Ewing St  
Seattle, WA 98119

Office: 206-236-1700 ext. 5  
www.seabornpiledriving.com

Scope of Work: We propose to remove 289 sqft of the existing dock, remove the existing moorage cover, relocate the existing boat lift, repair 259 sqft of the existing dock, install 263 sqft of new dock, drive (12) new piles, remove (16) existing piles, repair (4) existing piles, and drive (1) new mooring pile.

County: King County  
Location: Lake Washington  
Applicant: Aqua Dock  
6855 W. Mercer Way  
Mercer Island, WA 98040  
Datum: CORPS OF ENGINEERS 1919  
SW Quarter Of Section 24, Township 14, Range 05  
Adjacent Owners:  
WANG ZHUO+JUNE  
6839 W MERCER WAY  
HAGSTROM COLIN S+JILLIAN J  
7428 SE 71ST ST 98040  
Created: 11/08/23  
Last Updated: 12/9/2024 3:16 PM Kady  
**SHEET 1.0**  
NWS-2023-XXX  
PAGE 1 OF 14

# GENERAL NOTES:

**MATERIALS SPEC LIST:**

**Boat Lifts:** Aluminum

- \* SL10014ARW - 146" x 191"

**Decking Material:** FRPP - Fiberglass reinforced polypropylene

Light permeable percentage:

- \* Surface - 43%
- \* 18" Dock Height - 61%

**Sewer:**

- \* All sewer is field verified by probing the lake bed manually during the allowed work windows for the area.

**Piles:**

- \* All new piles are epoxy coated 8" steel piles
- \* Repair piles are done as a sleeve/strap method
- \* All Pile tops exposed will have a conical cap placed on top
- \* Piles are driven using the vibro method

**Preservatives**

- \* Structural Glued Laminated timber shall be alaskan cedar AC.AC. 20f-V12
- \* Wood Shall be seasoned dry with a maximum moisture content of 19%
- \* Preservative treated wood shall conform to the american wood protection association (AWP) UC4A. All wood shall bear a treatment identification mark by the certifying agency.

CODE REFERENCES: Mercer Island

**We are applying for the permit to be reviewed under the:**

"Development Standards for New and Expanded Moorage Facilities" per MIMC 19.13050(F)(1).

F. Moorage Facilities. All permits for new and expanded moorage facility, other than public access piers or boardwalks, shall meet the following standards unless otherwise exempted. Moorage facilities have the option of meeting either the development standards prescribed in subsection (F)(1) or (F)(2) of this section, or the "alternative development standards" in subsection (F)(3) of this section.

i. Development Standards for New and Expanded Moorage Facilities. A proposed moorage facility shall be presumed to not create a net loss of ecological functions pursuant to subsection (B)(2) of this section if:

- i. The surface coverage area of the moorage facility is:
  - a. Four hundred eighty square feet or less for a single property owner;
  - b. Seven hundred square feet or less for two residential property owners (residential); or
  - c. One thousand square feet or less for three or more residential property owners;

**No net loss report attached.**

ii. Piers, docks, and platform lifts must be fully grated with materials that allow a minimum of 40 percent light transmittance;

**Dock will be a grated material with at least 40% light transmittance.**

iii. Vegetation. The code official approves a vegetation plan that conforms to the following: Ch. 19.13 Shoreline Master Program | Mercer Island City Code Page 27 of 34 The Mercer Island City Code is current through Ordinance 20C-13, passed June 16, 2020. Vegetation must be planted as provided in Figure C and as follows: Within the 25-foot shoreline setback, a 20-foot vegetation area shall be established, measured landward from the OHWM. Twenty-five percent of the area shall contain vegetation coverage. The five feet nearest the OHWM shall contain at least 25 percent native vegetation coverage. A shoreline vegetation plan shall be submitted to the city for approval. The vegetation coverage shall consist of a variety of ground cover shrubs and trees, excluding nonnative grasses. No plants on the current King County noxious weed lists shall be planted within the shorelands. Figure C: Vegetation Plan

**The vegetation plan will conform to these standards. See page 11 and 12.**

iv. Only docks, ramps, and boatlifts may be within the first 30 feet from the OHWM. No skirting is allowed on any structure;

**Only the dock will be within the first 30 feet of the OHWM.**

v. The height above the OHWM for docks shall be a minimum of one and one-half feet and a maximum of five feet;

**The height of the dock above the OHWM will be 14".**

vi. The first in-water (nearest the OHWM) set of pilings shall be steel, 10 inches in diameter or less, and at least 18 feet from the OHWM. Piling sets beyond the first shall also be spaced at least 18 feet apart and shall not be greater than 12 inches in diameter. Piles shall not be treated with pentachlorophenol, creosote, CCA or comparably toxic compounds. If ammoniacal copper zinc arsenate (ACZA) pilings are proposed, the applicant shall meet all of the best management practices, including a post-treatment procedure, as outlined in the amended Best Management Practices of the Western Wood Preservers. All piling sizes are in nominal diameter;

**All new piles will be epoxy coated steel piles measuring 8" in diameter. All repaired piles will be repaired with epoxy coated steel sleeves.**

vii. Any paint, stain or preservative applied to components of the dock must be leach resistant, completely dried or cured prior to installation. Materials shall not be treated with pentachlorophenol, creosote, CCA or comparably toxic compounds; Ch. 19.13 Shoreline Master Program | Mercer Island City Code Page 28 of 34 The Mercer Island City Code is current through Ordinance 20C-13, passed June 16, 2020.

**No material will be treated with a toxic compound.**

viii. No more than two mooring piles shall be installed per structure. Joint-use structures may have up to four mooring piles. The limits include existing mooring piles. Moorage piling shall not be installed within 30 feet of the OHWM. These piles shall be as far offshore as possible;

**No mooring piles are proposed.**

ix. The applicant shall abide by the work windows for listed species established by the U.S. Army Corps of Engineers and Washington Fish and Wildlife; and

**Work will only be done within the work windows specified.**

x. Disturbance of bank vegetation shall be limited to the minimum amount necessary to accomplish the project. Disturbed bank vegetation shall be replaced with native, locally adapted herbaceous and/or woody vegetation. Herbaceous plantings shall occur within 48 hours of the completion of construction. Woody vegetation components shall be planted in the fall or early winter, whichever occurs first. The applicant shall take appropriate measures to ensure revegetation success.

**No bank vegetation will be disturbed.**

Mitigation" Disturbance of bank vegetation shall be limited to the minimum amount necessary to accomplish the project. Disturbed bank vegetation shall be replaced with native, locally adapted herbaceous and/or woody vegetation. Herbaceous plantings shall occur within 48 hours of the completion of construction. Woody vegetation components shall be planted in the fall or early winter, whichever occurs first. The applicant shall take appropriate measures to ensure revegetation success;

Piers legally established and parcels joined under SUB 09-04 DEC 2009

The non-conformity created by the consolidation of parcels under SUB09-004 may continue under 19.01.050 -Nonconforming structures, sites, lots and uses.

County: King County  
Location: Lake Washington

Applicant: Aqua Dock  
6855 W. Mercer Way  
Mercer Island, WA 98040

Datum: CORPS OF ENGINEERS 1919  
SW Quarter Of Section 24, Township 14, Range 05

Adjacent Owners:  
HAGSTROM COLLIN S+JILLIAN J  
7428 SE 71ST ST 98040

Last Updated: 12/9/2024 3:16 PM Kady

Created: 11/08/23



Seaborn Pile Driving  
1080 W Ewing St  
Seattle, WA 98119

Office: 206-236-1700 ext. 5  
www.seabornpiledriving.com

Scope of Work: We propose to remove 289 sqft of the existing dock, remove the existing moorage cover, relocate the existing boat lift, repair 259 sqft of the existing dock, install 263 sqft of new dock, drive (12) new piles, remove (16) existing piles, repair (4) existing piles, and drive (1) new mooring pile.

**SHEET  
2.0**

# EXISTING CONDITIONS

## \*\*CLEAN UP LAKE AROUND PROJECT\*\*

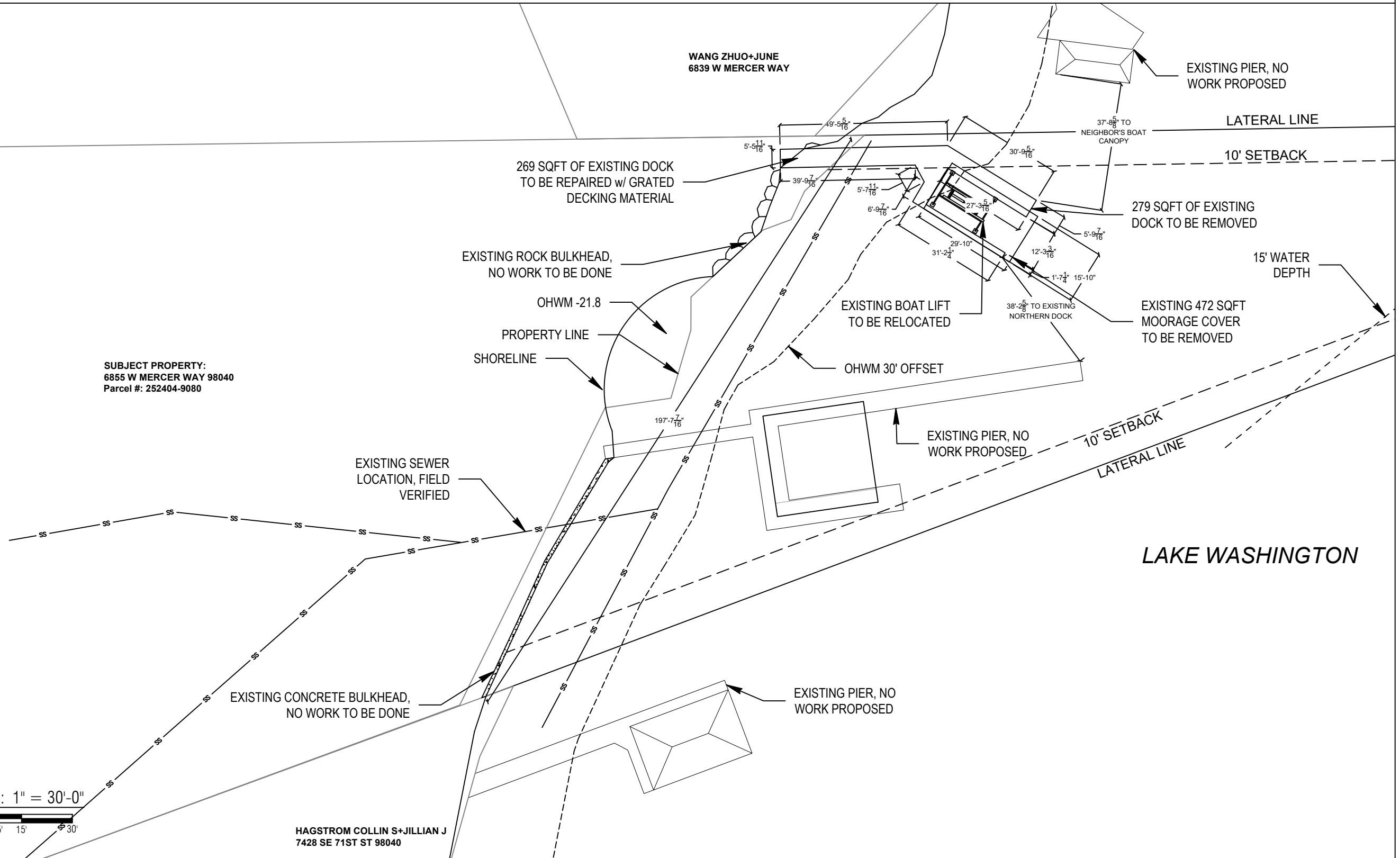

SUBJECT PROPERTY:  
6855 W MERCER WAY 98040  
Parcel #: 252404-9080

EXISTING SEWER  
LOCATION, FIELD  
VERIFIED

EXISTING CONCRETE BULKHEAD,  
NO WORK TO BE DONE

EXISTING PIER, NO  
WORK PROPOSED

EXISTING PIER, NO  
WORK PROPOSED

LAKE WASHINGTON

SCALE: 1" = 30'-0"

0' 7.5' 15' 30'

HAGSTROM COLLIN S+JILLIAN J  
7428 SE 71ST ST 98040

WANG ZHUO+JUNE  
6839 W MERCER WAY

County: King County  
Location: Lake Washington

Applicant: Aqua Dock  
6855 W. Mercer Way  
Mercer Island, WA 98040

Datum: CORPS OF ENGINEERS 1919  
SW Quarter Of Section 24, Township 14, Range 05  
Adjacent Owners:  
HAGSTROM COLLIN S+JILLIAN J  
7428 SE 71ST ST 98040  
WANG ZHUO+JUNE  
6839 W MERCER WAY

SHEET  
3.0

NWS-2023-XXX  
PAGE 3 OF 14

Last Updated: 12/9/2024 3:16 PM Kady

Created: 11/08/23



Seaborn Pile Driving  
1080 W Ewing St  
Seattle, WA 98119

Office: 206-236-1700 ext. 5  
www.seabornpiledriving.com

Scope of Work: We propose to remove 289 sqft of the existing dock, remove the existing moorage cover, relocate the existing boat lift, repair 259 sqft of the existing dock, install 263 sqft of new dock, drive (12) new piles, remove (16) existing piles, repair (4) existing piles, and drive (1) new mooring pile.

# PROPOSED CONDITIONS

## \*\*CLEAN UP LAKE AROUND PROJECT\*\*

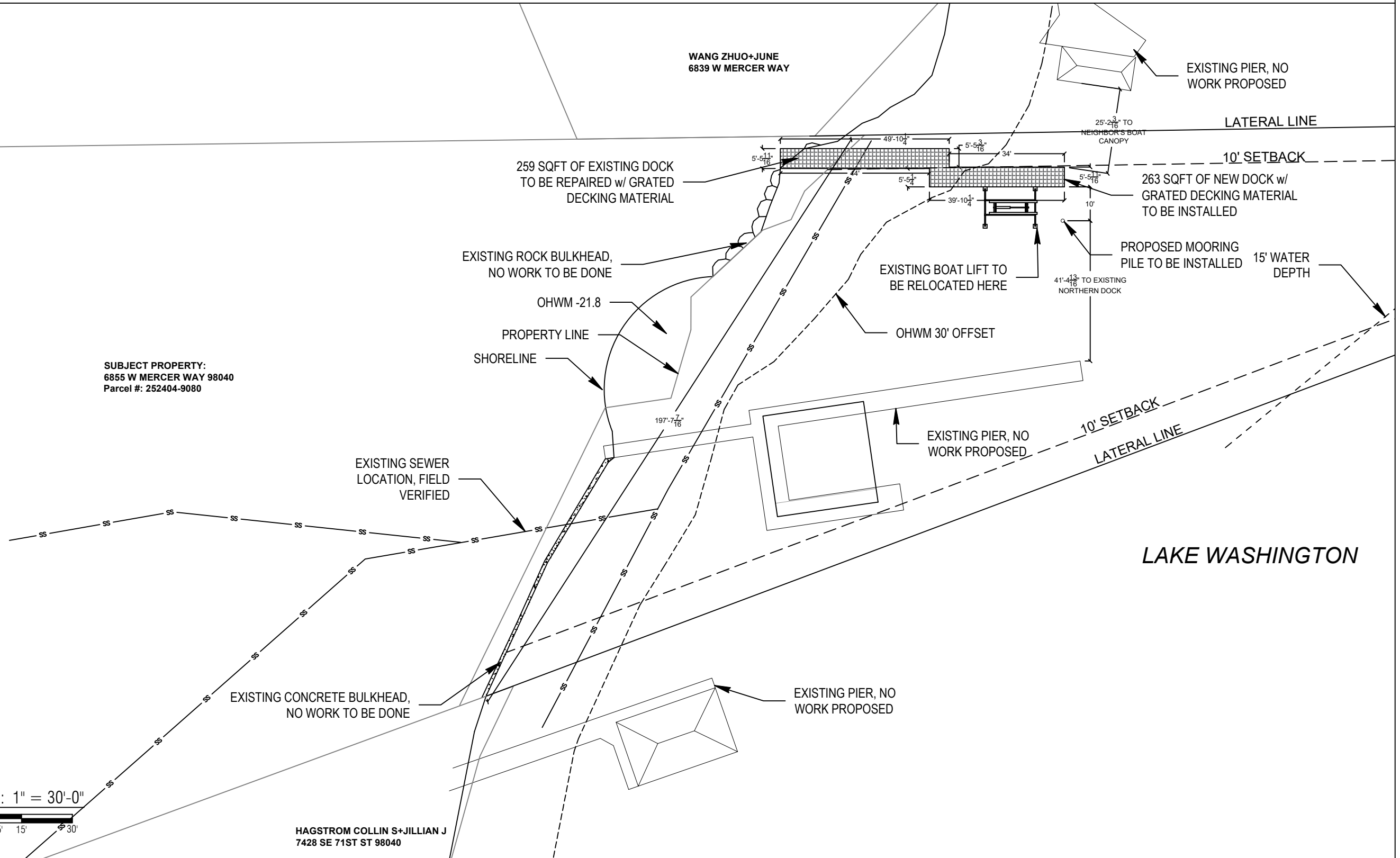

SUBJECT PROPERTY:  
6855 W MERCER WAY 98040  
Parcel #: 252404-9080

HAGSTROM COLLIN S+JILLIAN J  
7428 SE 71ST ST 98040

SCALE: 1" = 30'-0"  
0' 7.5' 15' 30'



Seaborn Pile Driving  
1080 W Ewing St  
Seattle, WA 98119

Office: 206-236-1700 ext. 5  
www.seabornpiledriving.com

Scope of Work: We propose to remove 289 sqft of the existing dock, remove the existing moorage cover, relocate the existing boat lift, repair 259 sqft of the existing dock, install 263 sqft of new dock, drive (12) new piles, remove (16) existing piles, repair (4) existing piles, and drive (1) new mooring pile.

County: King County  
Location: Lake Washington

Applicant: Aqua Dock  
6855 W. Mercer Way  
Mercer Island, WA 98040

Datum: CORPS OF ENGINEERS 1919  
SW Quarter Of Section 24, Township 14, Range 05

Adjacent Owners:  
HAGSTROM COLLIN S+JILLIAN J  
7428 SE 71ST ST 98040

Last Updated: 12/9/2024 3:16 PM Kady

Created: 11/08/23

**SHEET**  
**4.0**

NWS-2023-XXX  
PAGE 4 OF 14

# PIER DETAILS - EXISTING PLAN VIEW

## LEGEND

⊕ (4) EXISTING PILES - TO BE REPAIRED

○ (16) EXISTING PILES - TO BE REMOVED

Existing Pier Overwater: 529sqft

Existing Pier Total: 548 sqft

▨ Existing Pier To Be Repaired w/ Grated Decking: 259 sqft

□ Existing Pier To Be Removed: 289 sqft

\*\*Grated decking is 43% light permeable

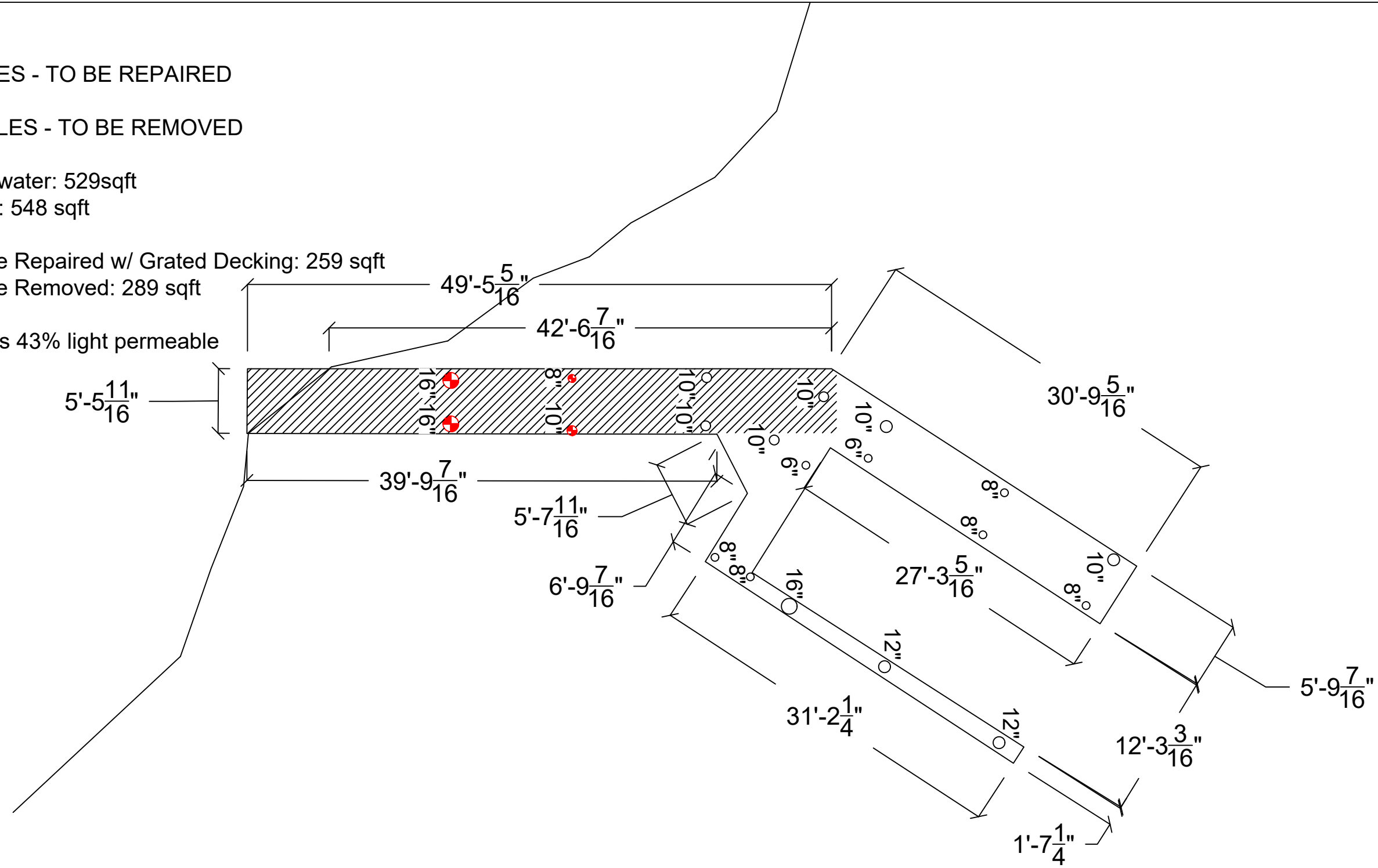

PLAN VIEW



Seaborn Pile Driving  
1080 W Ewing St  
Seattle, WA 98119

Office: 206-236-1700 ext. 5  
www.seabornpiledriving.com

Scope of Work: We propose to remove 289 sqft of the existing dock, remove the existing moorage cover, relocate the existing boat lift, repair 259 sqft of the existing dock, install 263 sqft of new dock, drive (12) new piles, remove (16) existing piles, repair (4) existing piles, and drive (1) new mooring pile.

County: King County  
Location: Lake Washington

Applicant: Aqua Dock  
6855 W. Mercer Way  
Mercer Island, WA 98040

Datum: CORPS OF ENGINEERS 1919  
SW Quarter Of Section 24, Township 14, Range 05

**SHEET**  
**5.0**

NWS-2023-XXX  
PAGE 5 OF 14

Created: 11/08/23  
WANG ZHUO+JUNE  
6839 W MERCER WAY  
Adjacent Owners:  
HAGSTROM COLIN S+JILLIAN J  
7428 SE 71ST ST 98040  
Last Updated: 12/9/2024 3:16 PM Kady

# PIER DETAILS - EXISTING PLAN VIEW

EXISTING

- (59) EXISTING LNFT CAPS
- (401) EXISTING LNFT PILES
- ▨ (499) EXISTING LNFT STRINGERS
- (165) EXISTING LNFT EDGE BEAMS

(1,124) TOTAL LNFT STRUCTURE ELEMENTS

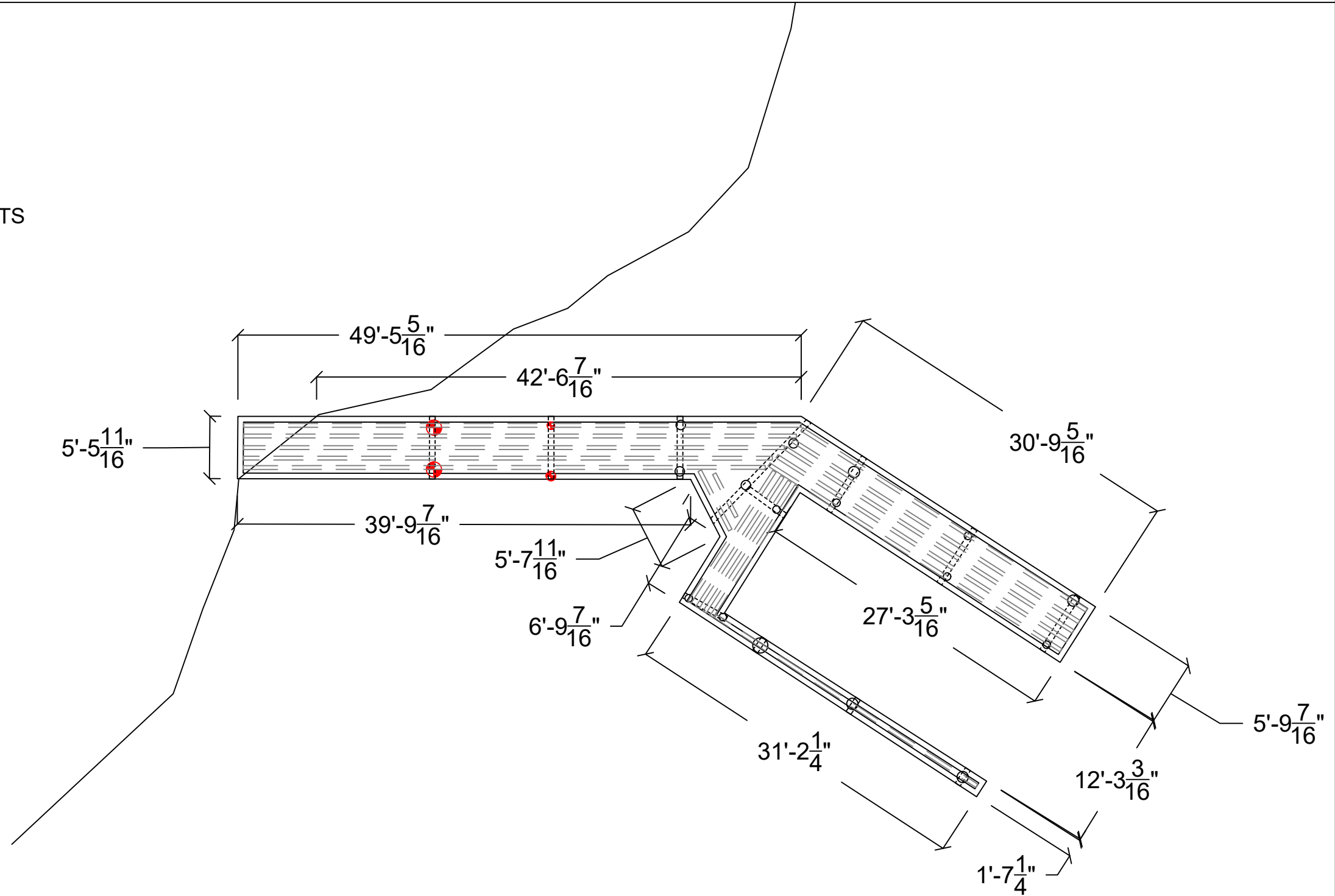

PLAN VIEW



Seaborn Pile Driving  
1080 W Ewing St  
Seattle, WA 98119

Office: 206-236-1700 ext. 5  
www.seabornpiledriving.com

Scope of Work: We propose to remove 289 sqft of the existing dock, remove the existing moorage cover, relocate the existing boat lift, repair 259 sqft of the existing dock, install 263 sqft of new dock, drive (12) new piles, remove (16) existing piles, repair (4) existing piles, and drive (1) new mooring pile.

County: King County  
Location: Lake Washington

Applicant: Aqua Dock  
6855 W. Mercer Way  
Mercer Island, WA 98040

Datum: CORPS OF ENGINEERS 1919  
SW Quarter Of Section 24, Township 14, Range 05

Adjacent Owners:  
HAGSTROM COLLIN S+JILLIAN J  
7428 SE 71ST ST 98040

WANG ZHUO+JUNE  
6839 W MERCER WAY

Created: 11/08/23  
Last Updated: 12/9/2024 3:16 PM Kady

**SHEET**  
**6.0**

# PIER DETAILS - PROPOSED PLAN VIEW

## LEGEND

- ⊕ (4) EXISTING PILES - TO BE REPAIRED
- (12) PROPOSED STEEL PILES - TO BE ADDED
- (1) PROPOSED MOORING PILE - TO BE ADDED

Proposed Pier Overwater: 468 sqft (GRATED DECKING MATERIAL)  
 Proposed Pier total: 489 sqft (GRATED DECKING MATERIAL)

\*\*Grated decking is 43% light permeable

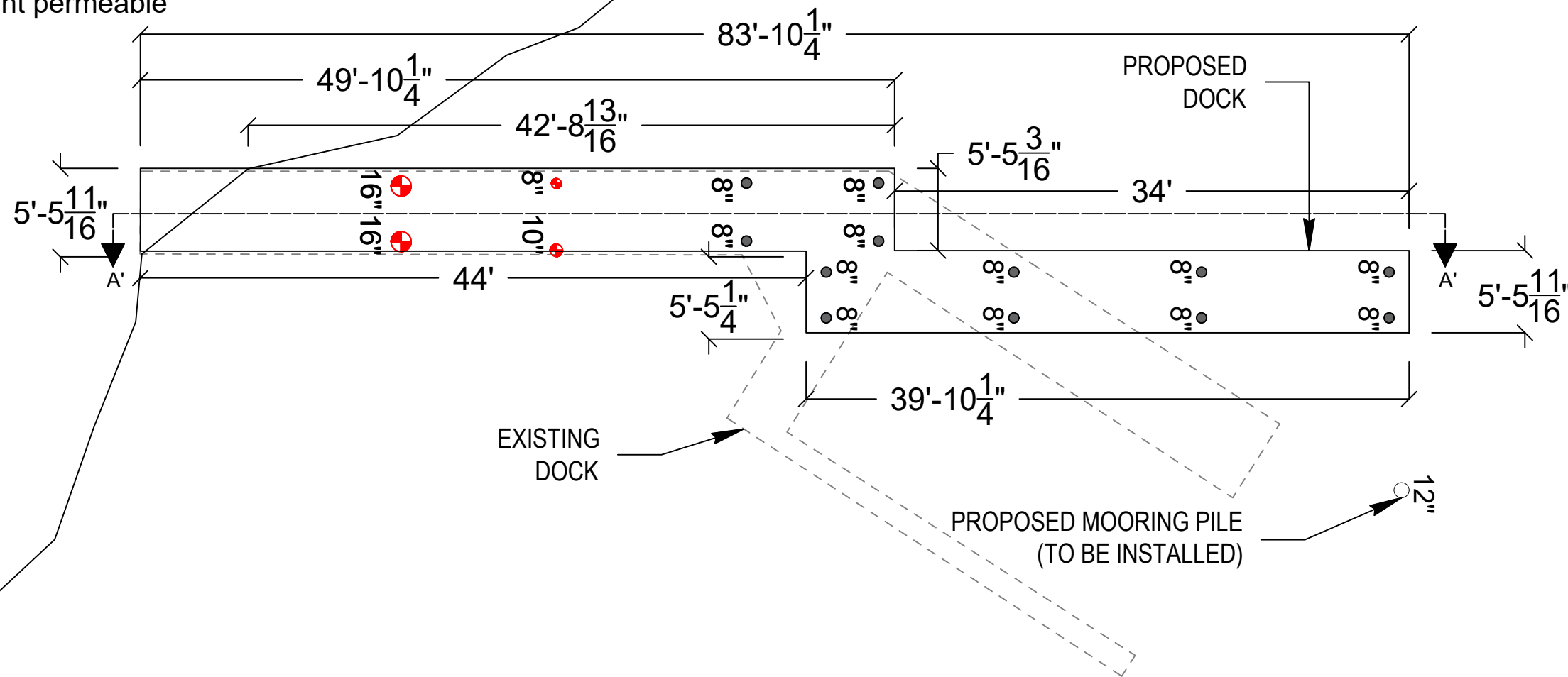

PLAN VIEW



Seaborn Pile Driving  
 1080 W Ewing St  
 Seattle, WA 98119





Office: 206-236-1700 ext. 5  
[www.seabornpiledriving.com](http://www.seabornpiledriving.com)

Scope of Work: We propose to remove 289 sqft of the existing dock, remove the existing moorage cover, relocate the existing boat lift, repair 259 sqft of the existing dock, install 263 sqft of new dock, drive (12) new piles, remove (16) existing piles, repair (4) existing piles, and drive (1) new mooring pile.

County: King County  
 Location: Lake Washington  
 Applicant: Aqua Dock  
 6855 W. Mercer Way  
 Mercer Island, WA 98040  
 Datum: CORPS OF ENGINEERS 1919  
 SW Quarter Of Section 24, Township 14, Range 05  
 Adjacent Owners:  
 HAGSTROM COLLIN S+JILLIAN J  
 7428 SE 71ST ST 98040  
 WANG ZHUO+JUNE  
 6839 W MERCER WAY  
 Created: 11/08/23  
 Last Updated: 12/9/2024 3:16 PM Kady  
**SHEET 6.0**  
 NWS-2023-XXX  
 PAGE 6 OF 14

# PIER DETAILS - PROPOSED PLAN VIEW

## TO BE REPAIRED

-  (40) EXISTING LNFT CAPS TO BE REPAIRED
-  (13) EXISTING LNFT PILES TO BE REPAIRED
-  (215) EXISTING LNFT STRINGERS TO BE REPAIRED
-  (197) EXISTING LNFT EDGE BEAMS TO BE REPAIRED

(465) TOTAL LNFT STRUCTURE ELEMENTS TO BE REPAIRED

$(465)/(1,124) = 41.4\%$

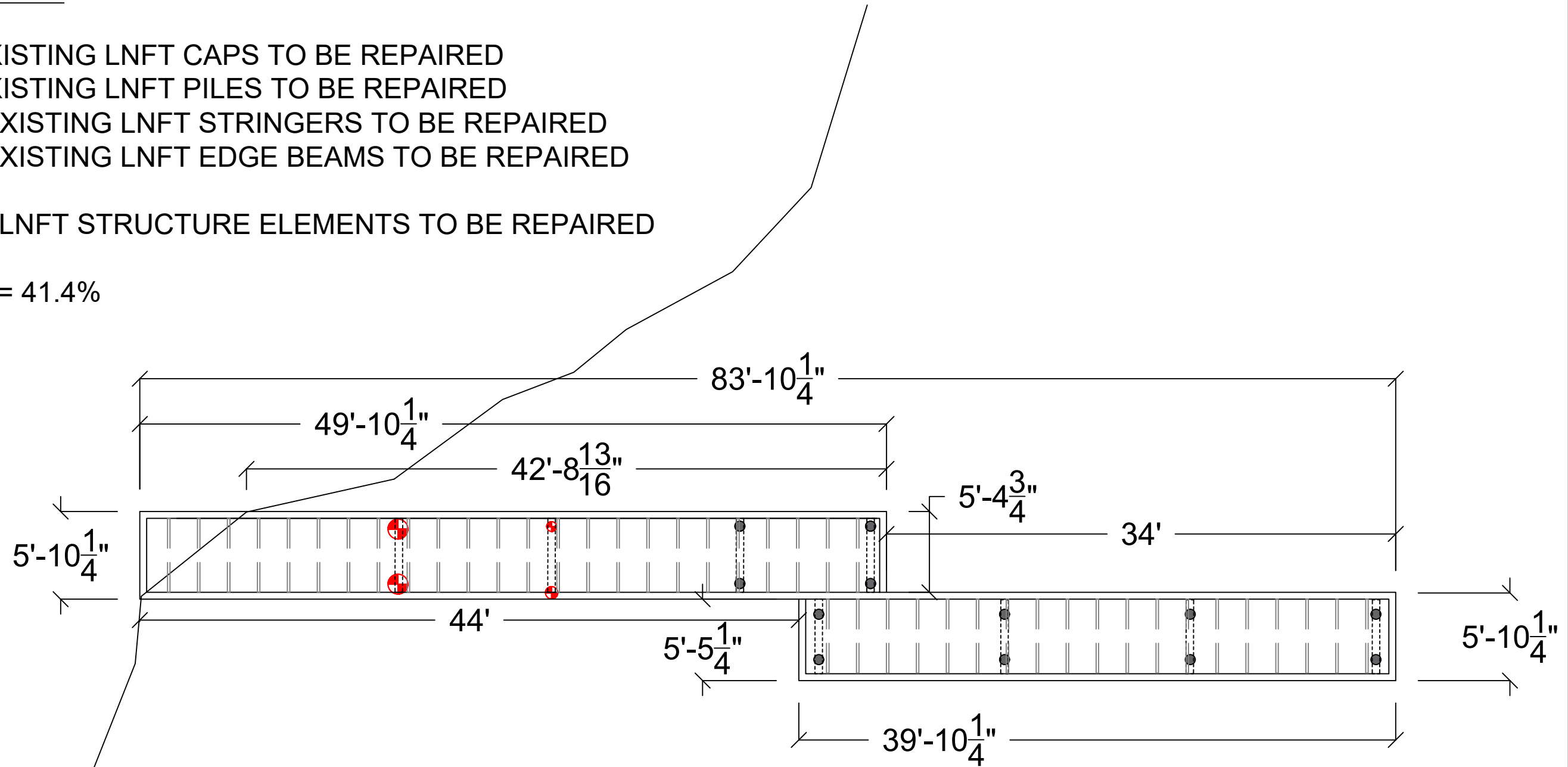

PLAN VIEW



Seaborn Pile Driving  
1080 W Ewing St  
Seattle, WA 98119

Office: 206-236-1700 ext. 5  
www.seabornpiledriving.com

Scope of Work: We propose to remove 289 sqft of the existing dock, remove the existing moorage cover, relocate the existing boat lift, repair 259 sqft of the existing dock, install 263 sqft of new dock, drive (12) new piles, remove (16) existing piles, repair (4) existing piles, and drive (1) new mooring pile.

County: King County  
Location: Lake Washington

Applicant: Aqua Dock  
6855 W. Mercer Way  
Mercer Island, WA 98040

Datum: CORPS OF ENGINEERS 1919  
SW Quarter Of Section 24, Township 14, Range 05

Adjacent Owners:  
HAGSTROM COLIN S+JILLIAN J  
7428 SE 71ST ST 98040

WANG ZHUO+JUNE  
6839 W MERCER WAY

**SHEET**  
**7.0**

NWS-2023-XXX  
PAGE 7 OF 14

Last Updated: 12/9/2024 3:16 PM Kady

Created: 11/08/23

# PIER DETAILS EXISTING/PROPOSED - SECTION VIEW

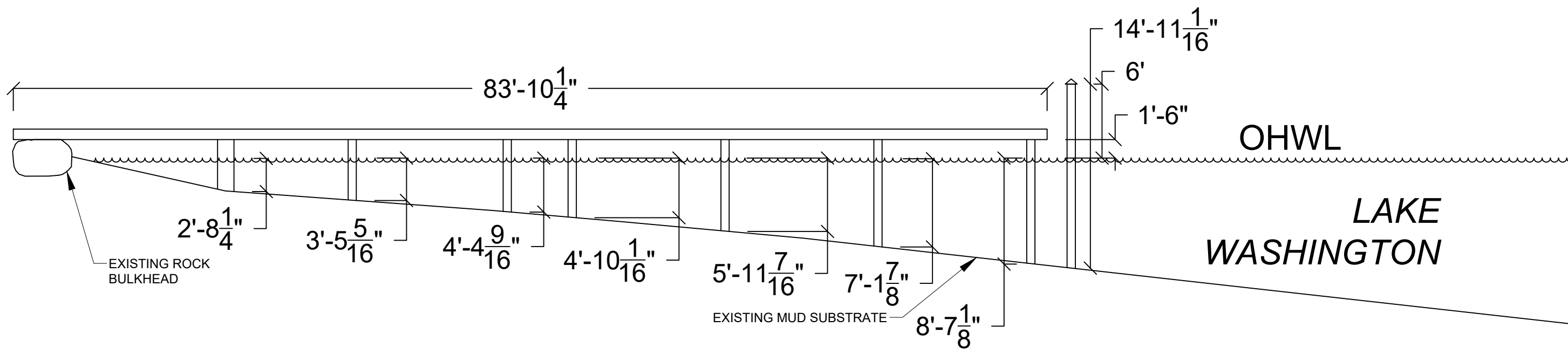

SECTION VIEW: A'-A'



Seaborn Pile Driving  
 1080 W Ewing St  
 Seattle, WA 98119  
 Office: 206-236-1700 ext. 5  
 www.seabornpiledriving.com

Scope of Work: We propose to remove 289 sqft of the existing dock, remove the existing moorage cover, relocate the existing boat lift, repair 259 sqft of the existing dock, install 263 sqft of new dock, drive (12) new piles, remove (16) existing piles, repair (4) existing piles, and drive (1) new mooring pile.

County: King County  
 Location: Lake Washington

Applicant: Aqua Dock  
 6855 W. Mercer Way  
 Mercer Island, WA 98040

Datum: CORPS OF ENGINEERS 1919  
 SW Quarter Of Section 24, Township 14, Range 05

Adjacent Owners:  
 HAGSTROM COLLIN S+JILLIAN J  
 7428 SE 71ST ST 98040

WANG ZHUO+JUNE  
 6839 W MERCER WAY

Created: 11/08/23  
 Last Updated: 12/9/2024 3:16 PM Kady

**SHEET**  
**7.0**

# BMP INFORMATION

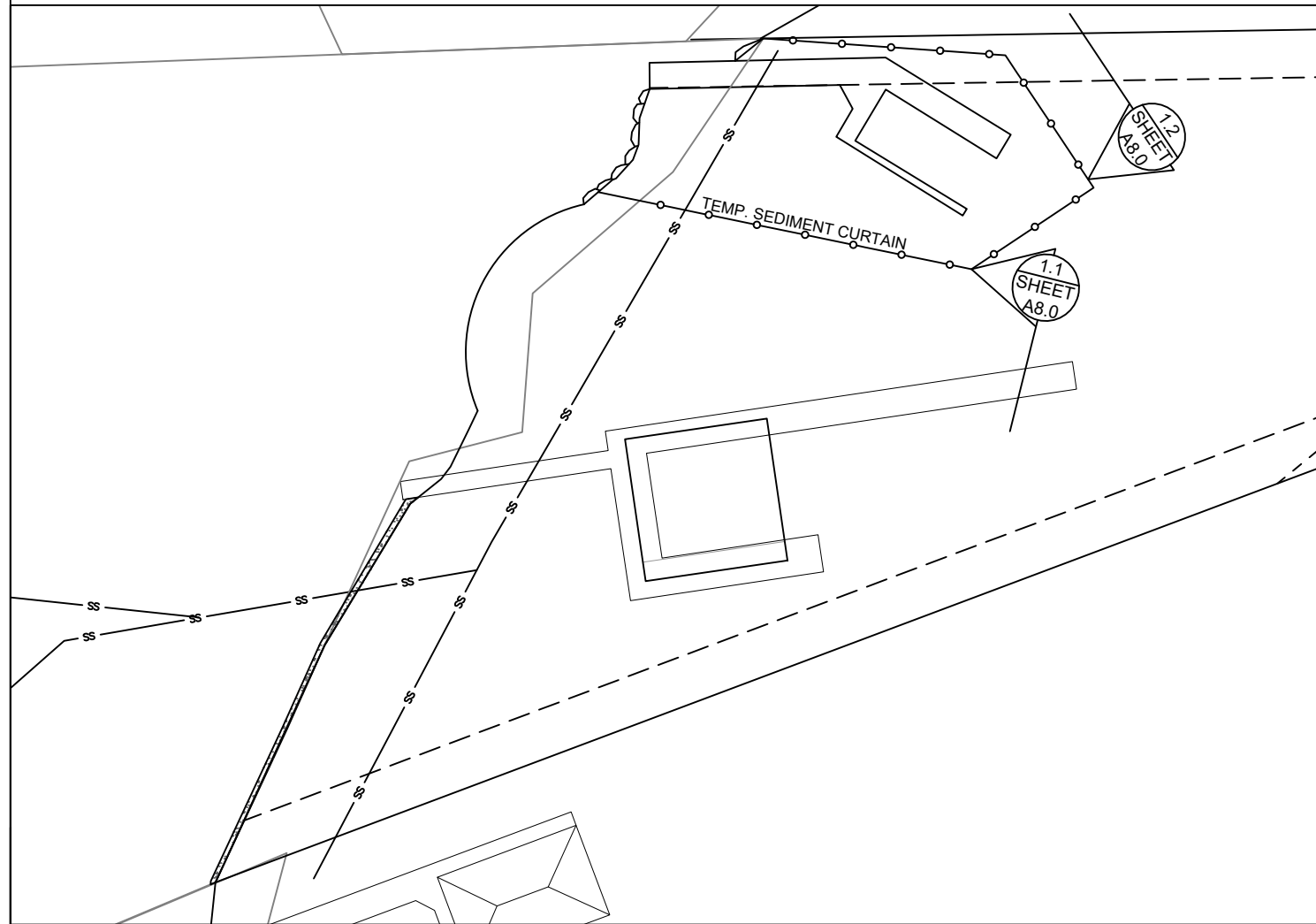

## BMP NOTES:

- A. Constant vigilance shall be kept for the presence of protected fish species during all aspects of the proposed action, particularly during in-water activities such as vessel movement, deployment of anchors & spuds, pile driving, dredging, and placement of gravels and other fill.
1. The project manager shall designate an appropriate number of competent observers to survey the project site and adjacent areas for protected species, including the presence of fish as conditions allow.
  2. Visual surveys shall be made prior to the start of work each day, and prior to resumption of work following any break of more than an hour. Periodic additional visual surveys throughout the work day are strongly recommended.
  3. All in-water work shall be done during the in-water work window for the waterbody. Where there is a difference between the USCOE and WDFW work windows, the overlap of the two shall apply.
  4. All pile driving and extraction shall be postponed or halted when obvious aggregations or schooling of fish are observed within 50 yards of that work, and shall only begin/resume after the animals have voluntarily departed the area.
  5. When piloting vessels, vessel operators shall operate at speeds and power settings to avoid grounding vessels, and minimize substrate scour and mobilization of bottom sediments.
- B. No contamination of the marine environment shall result from project-related activities.
1. Appropriate materials to contain and clean potential spills shall be stored and readily available at the work site and/or aboard project-related vessels.
  2. The project manager and heavy equipment operators shall perform daily pre-work equipment inspections for cleanliness and leaks. All heavy equipment operations shall be postponed or halted should a leak be detected, and shall not proceed until the leak is repaired and the equipment is cleaned.
  3. To the greatest extent practicable, utilize biodegradable oils for equipment that would be operated in or near water.
  4. Fueling of land-based vehicles and equipment shall take place at least 50 feet away from the water, preferably over an impervious surface. Fueling of vessels shall be done at approved fueling facilities.
  5. Turbidity and siltation from project-related work shall be minimized and contained through the appropriate use of erosion control practices, effective silt containment devices, and the curtailment of work during adverse weather and tidal/flow conditions.
  6. All wastes shall be collected and contained for proper disposal at approved upland disposal sites appropriate for the material(s).
  7. When removing piles and other similarly treated wood, containment curtain must fully enclose the work area. Wood debris, oils, and any other materials released into lake waters must be collected, removed, and properly disposed of at approved disposal sites.
  8. All in- and over-water wood cutting would be limited to the minimum required to remove the subject wood component, and all cutting work should be enclosed within floating containment curtain.
  9. When removing piles, no actions shall be taken that would cause adhering sediments to return to lake waters.
  10. Above-water containment shall be installed around removed piles to prevent sediment laden waters from returning to lake waters.
  11. Construction staging (including stocking of materials, etc.) will occur on the supply barge.
  12. All Exposed wood to be used on the project will be treated with a an agency approved treatment.

DETAIL 1.1

DETAIL 1.2

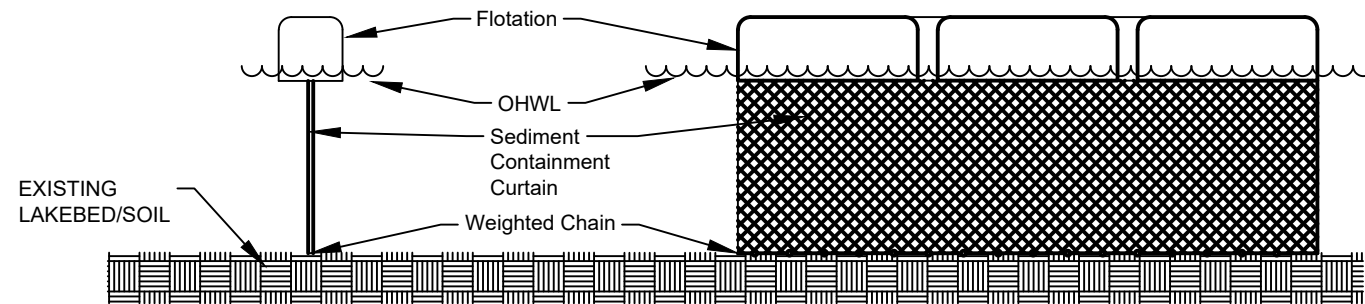

DETAIL 1.1 & 1.2



Seaborn Pile Driving  
1080 W Ewing St  
Seattle, WA 98119

Office: 206-236-1700 ext. 5  
www.seabornpiledriving.com

Scope of Work: We propose to remove 289 sqft of the existing dock, remove the existing moorage cover, relocate the existing boat lift, repair 259 sqft of the existing dock, install 263 sqft of new dock, drive (12) new piles, remove (16) existing piles, repair (4) existing piles, and drive (1) new mooring pile.

County: King County  
Location: Lake Washington

Applicant: Aqua Dock  
6855 W. Mercer Way  
Mercer Island, WA 98040

Datum: CORPS OF ENGINEERS 1919  
SW Quarter Of Section 24, Township 14, Range 05

Adjacent Owners:  
HAGSTROM COLLIN S+JILLIAN J  
7428 SE 71ST ST 98040

Last Updated: 12/9/2024 3:16 PM Kady

Created: 11/08/23

**SHEET**  
**8.0**

# MITIGATION PLAN

5' SETBACK VEGETATION COVERAGE - 38.3%  
20' SETBACK VEGETATION COVERAGE - 25.2%

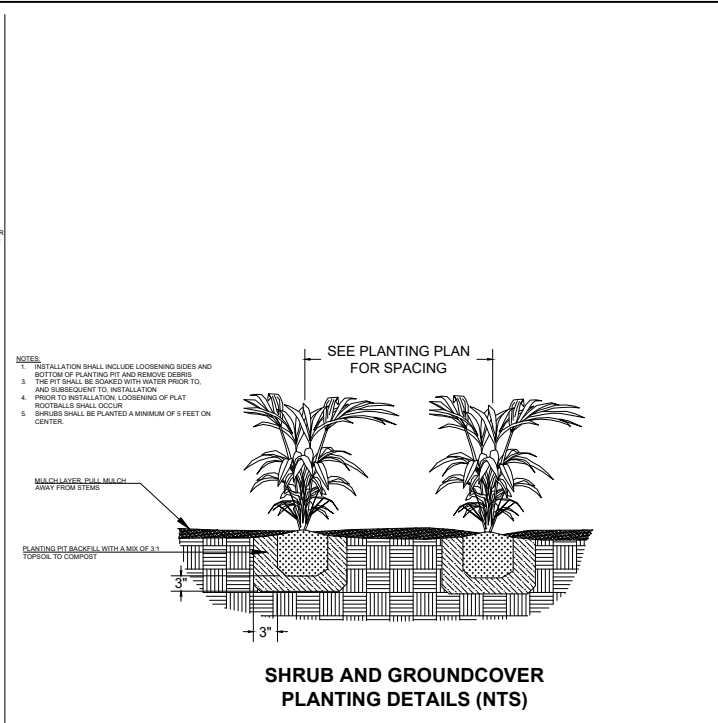
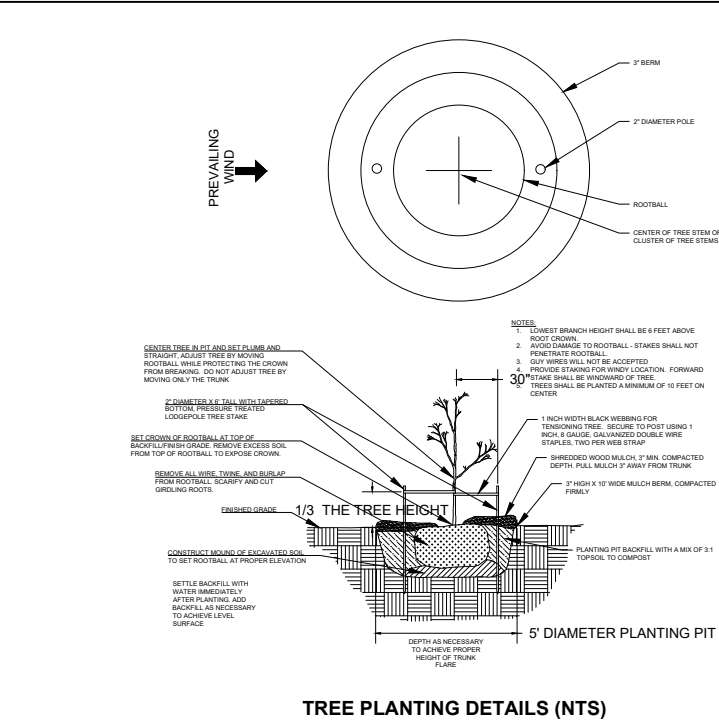
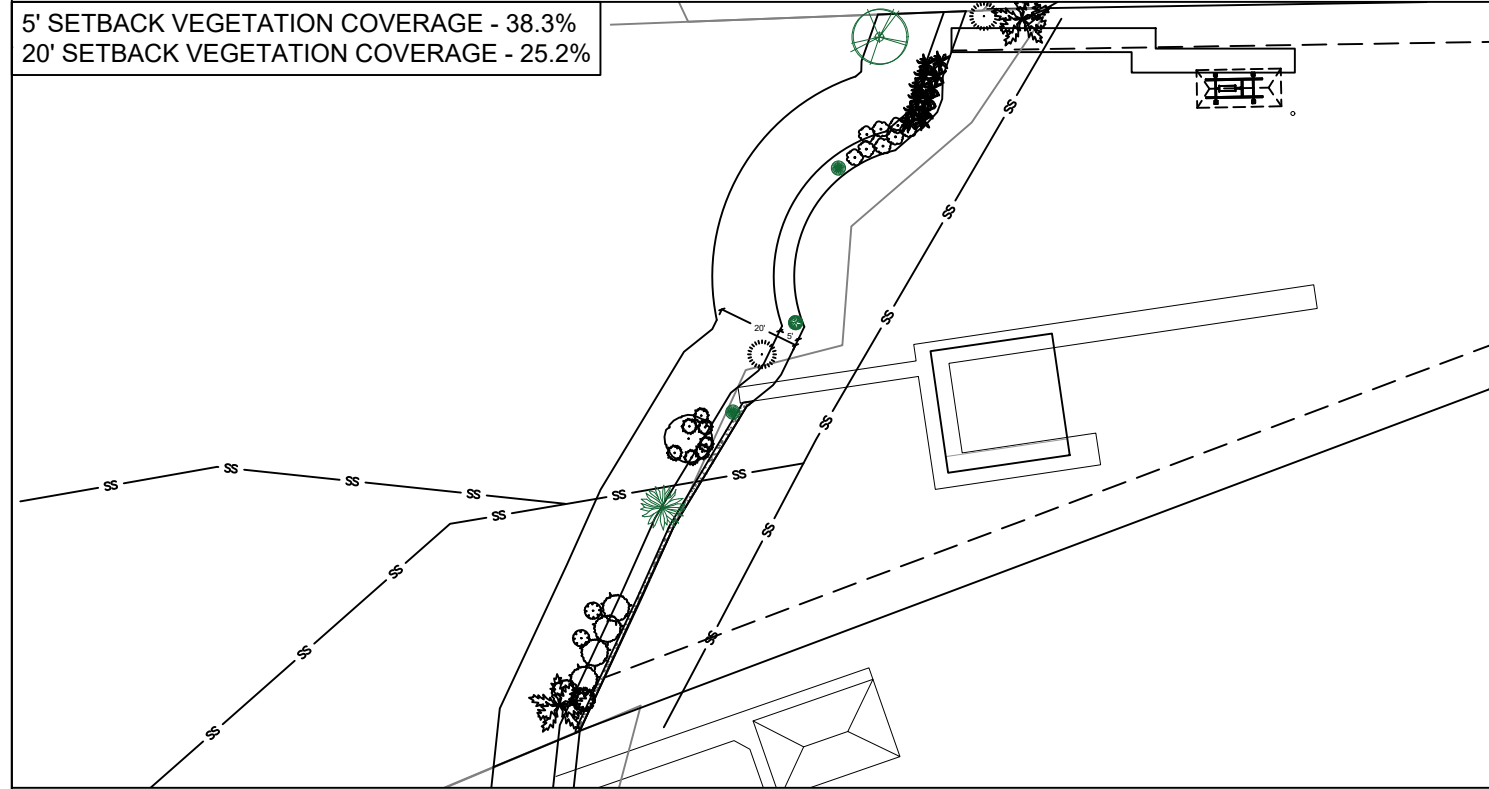

- Notes:**
- The property owner shall implement and abide by the shoreline planting plan, including the installation of the identified species, in the identified locations. Shrubs shall be planted at least five feet on center, and trees shall be planted at least ten feet on center.
  - For best plant survival, planting should be completed the first October through March period concurrent with or immediately following the work authorized by this permit. A report, as-built drawing and photographs demonstrating the plants have been installed or a report on the status of project construction will be submitted to the U.S. Army Corps of Engineers, Seattle District, Regulatory Branch, within 12 months from the date of permit issuance. This reporting requirement may be met by completing and submitting a U.S. Army Corps of Engineers approved Report for Mitigation Work Completion form.
  - The property owner shall preserve in good health 100% of shoreline planting plan vegetation for as long as the structures that have been permitted under the RAP program remain in place. Plants that die must be replaced with the appropriate plant type (i.e. tree for tree, shrub for shrub) from the RAP Plant List.
  - The property owner shall monitor the survival of shoreline planting plan vegetation for five years (Monitoring Years 1-5) after the U.S. Army Corps of Engineers accepts the as-built report. The property owner shall also submit annual monitoring reports to the U.S. Army Corps of Engineers each year during this period. Each annual monitoring report will include written and photographic documentation that the performance standards are being met, including documentation of plant mortality and replacement. Photos will be taken from established points and used repeatedly for each monitoring year. In addition to photos at designated points, photo documentation will include a panoramic view of the entire planting area. Submitted photos will be formatted on standard 8 1/2 x 11" paper, dated with the date the photo was taken, and clearly labeled with the direction from which the photo was taken. The photo location points will be identified on an appropriate drawing. Annual shoreline planting monitoring reports will be submitted to the U.S. Army Corps of Engineers, Seattle District, Regulatory Branch, by November 31 of each monitoring year. This reporting requirement may be met by completing and submitting a U.S. Army Corps of Engineers approved Mitigation Planting Monitoring Report form.

## PROPOSED PLANTING SPECIES/QUANTITIES

SYMBOL	LATIN NAME	COMMON NAME	QTY	SIZE
	<i>Thuja plicata</i>	Western Red Cedar	1	3 ft
	<i>Pinus contorta v contorta</i>	Shore pine	1	3 ft
	<i>Rosa nutkana</i>	Nootka Rose	1	1 Gallon
	<i>Philadelphus lewisii</i>	Mock Orange	2	1 Gallon

PLANTS: Shrubs to be installed 5ft on center and trees to be installed 10ft on center.



Seaborn Pile Driving  
1080 W Ewing St  
Seattle, WA 98119  
Office: 206-236-1700 ext. 5  
www.seabornpiledriving.com

Scope of Work: We propose to remove 289 sqft of the existing dock, remove the existing moorage cover, relocate the existing boat lift, repair 259 sqft of the existing dock, install 263 sqft of new dock, drive (12) new piles, remove (16) existing piles, repair (4) existing piles, and drive (1) new mooring pile.

County: King County  
Location: Lake Washington  
Applicant: Aqua Dock  
6855 W. Mercer Way  
Mercer Island, WA 98040  
Datum: CORPS OF ENGINEERS 1919  
SW Quarter Of Section 24, Township 14, Range 05  
Adjacent Owners:  
HAGSTROM COLLIN S+JILLIAN J  
7428 SE 71ST ST 98040  
WANG ZHUO+JUNE  
6839 W MERCER WAY  
Created: 11/08/23  
Last Updated: 12/9/2024 3:16 PM Kady  
SHEET  
9.0  
NWS-2023-XXX  
PAGE 9 OF 14





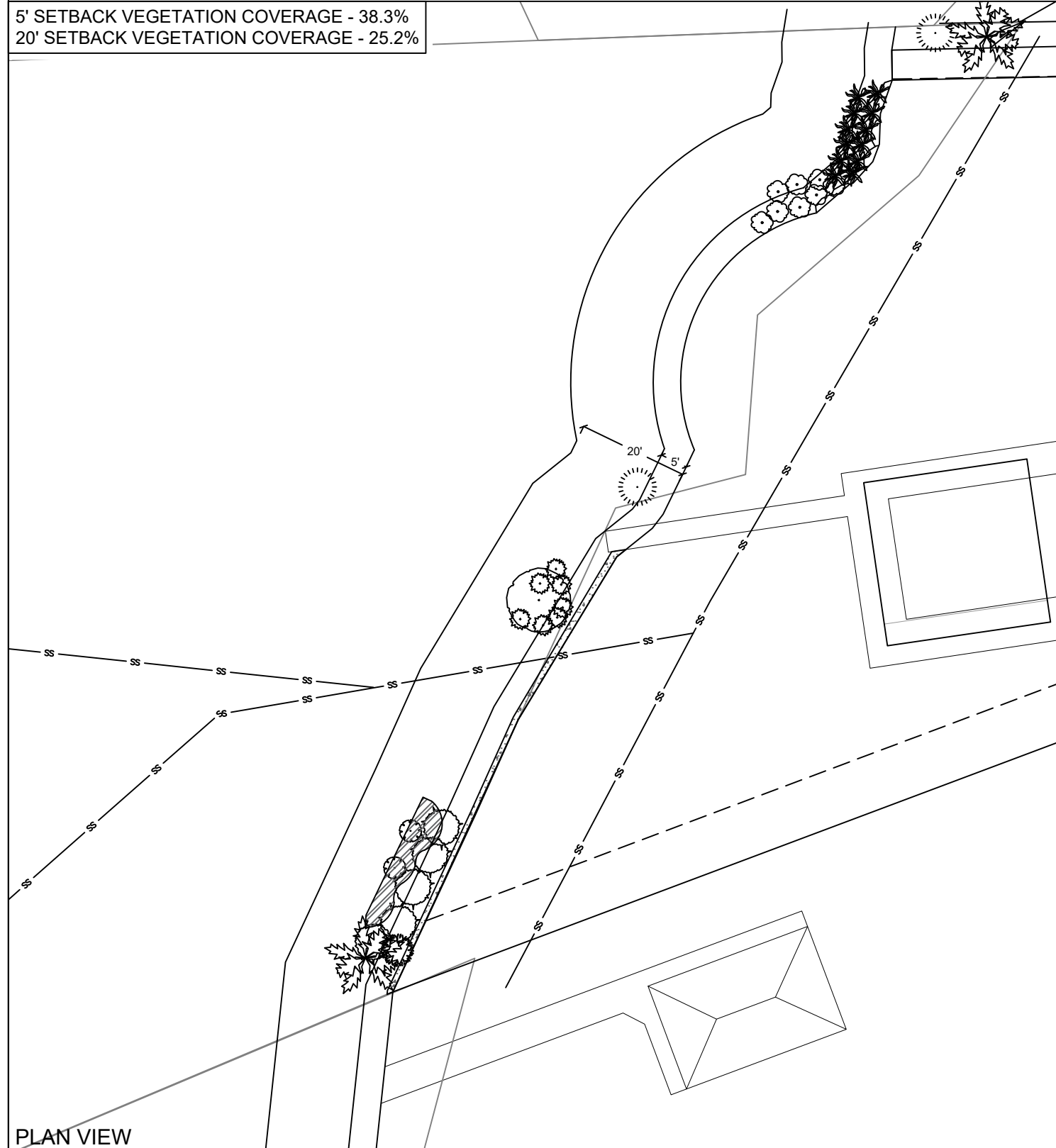



# EXISTING PLANT PLAN

5' SETBACK VEGETATION COVERAGE - 38.3%  
 20' SETBACK VEGETATION COVERAGE - 25.2%

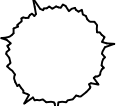
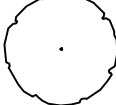

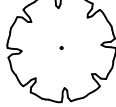
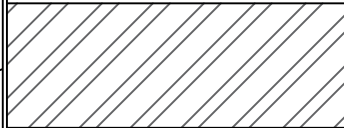
PLAN VIEW

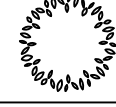
## EXISTING PLANTING SPECIES/QUANTITIES

SYMBOL	SCIENTIFIC NAME	COMMON NAME	QTY	SIZE
	<i>Phyllostachys area</i>	Bamboo	N/A	~3'x15'x12'
	<i>Phormium tenax</i>	Flax	1	~2ft
	<i>Ficus mrcrocarpa</i>	Fig Tree	5	~ 3ft
	<i>Acer circinatum</i>	Vine Maple	1	~ 8ft
	<i>Cenchrus setaceus</i>	Rose fountain grass	N/A	N/A
	<i>Pseudognaphalium microphalum</i>	Rabbit tobacco	N/A	N/A
	<i>Impatiens hawkeri</i>	Impatiens	N/A	N/A
	<i>Thuja picatta</i>	Western Redcedar	2	~ 5ft
	<i>Rosa nutkana</i>	Nootka Rose	1	~ 3 ft
	<i>Philadelphus lewisii</i>	Mock Orange	2	~ 3 ft

EXISTING PLANTS TABLE



Seaborn Pile Driving  
 1080 W Ewing St  
 Seattle, WA 98119

Office: 206-236-1700 ext. 5  
[www.seabornpiledriving.com](http://www.seabornpiledriving.com)

Scope of Work: We propose to remove 289 sqft of the existing dock, remove the existing moorage cover, relocate the existing boat lift, repair 259 sqft of the existing dock, install 263 sqft of new dock, drive (12) new piles, remove (16) existing piles, repair (4) existing piles, and drive (1) new mooring pile.

County: King County  
 Location: Lake Washington

Applicant: Aqua Dock  
 6855 W. Mercer Way  
 Mercer Island, WA 98040

Datum: CORPS OF ENGINEERS 1919  
 SW Quarter Of Section 24, Township 14, Range 05

Adjacent Owners:  
 HAGSTROM COLIN S+JILLIAN J  
 7428 SE 71ST ST 98040

Last Updated: 12/9/2024 3:16 PM Kady

Created: 11/08/23

**SHEET**  
**10.0**

# GENERAL ENGINEERING NOTES:

## GENERAL

- ALL CONSTRUCTION SHALL CONFORM TO THESE PLANS.
- CONTRACTOR SHALL VERIFY ALL LEVELS, DIMENSIONS, AND EXISTING CONDITIONS IN THE FIELD BEFORE PROCEEDING. CONTRACTOR SHALL NOTIFY THE ENGINEER OF ANY DISCREPANCIES OR FIELD CHANGES PRIOR TO INSTALLATION OR FABRICATION. IN CASE OF DISCREPANCIES BETWEEN THE EXISTING CONDITIONS AND THE DRAWINGS, THE CONTRACTOR SHALL OBTAIN DIRECTION FROM THE ENGINEER BEFORE PROCEEDING. DIMENSIONS NOTED AS PLUS OR MINUS ( $\pm$ ) OR REF INDICATE UNVERIFIED DIMENSIONS AND ARE APPROXIMATE. NOTIFY ENGINEER IMMEDIATELY OF CONFLICTS OR EXCESSIVE VARIATIONS FROM INDICATED DIMENSIONS, NOTED DIMENSIONS TAKE PRECEDENCE OVER SCALED DIMENSIONS – DO NOT SCALE DRAWINGS. DIMENSIONS OF EXISTING CONDITIONS ARE BASED ON RECORD DRAWINGS AND ARE TO BE FIELD-VERIFIED BY THE CONTRACTOR.
- CONTRACTOR SHALL PROVIDE ADEQUATE SHORING AND BRACING OF ALL STRUCTURAL MEMBERS AND EXISTING MEMBERS, AS REQUIRED, AND IN A MANNER SUITABLE TO WORK SEQUENCE. TEMPORARY SHORING AND BRACING SHALL NOT BE REMOVED UNTIL ALL FINAL CONNECTIONS HAVE BEEN COMPLETED IN ACCORDANCE WITH THE DRAWINGS AND MATERIALS HAVE ACHIEVED DESIGN STRENGTH.
- CONTRACTOR SHALL BE RESPONSIBLE FOR ALL SAFETY PRECAUTIONS AND THE METHODS, TECHNIQUES, SEQUENCES AND PROCEDURES REQUIRED TO PERFORM THE WORK.
- ALL MATERIALS SHALL BE NEW, UNO.
- ALL WORK SHALL BE PERFORMED IN STRICT ACCORDANCE WITH THE DRAWINGS, NOTES, AND MANUFACTURER RECOMMENDATIONS. IF THERE ARE ANY CONFLICTS BETWEEN THESE DOCUMENTS, THE ENGINEER SHALL BE CONTACTED FOR DIRECTION.
- THE CONTRACTOR SHALL CAREFULLY DECONSTRUCT EXISTING ELEMENTS AS NECESSARY TO ACCESS THE WORK AREAS. SUCH DECONSTRUCTION MAY INCLUDE, INTERIOR AND EXTERIOR FINISHES. ALL DECONSTRUCTION ELEMENTS SHALL BE RECONSTRUCTED TO MATCH THE ORIGINAL APPEARANCE AND MEET THE REQUIREMENTS OF THE INTERNATIONAL BUILDING CODE.
- ALL MOORAGE COVERS AND LIFTS SHALL BE FREESTANDING AND SHALL NOT BE ATTACHED TO THE DOCK, UNLESS NOTED OTHERWISE.

## CODES AND STANDARDS

- ALL METHODS AND MATERIALS SHALL CONFORM TO THE INTERNATIONAL BUILDING CODE, 2018 EDITION.
- AMERICAN SOCIETY OF CIVIL ENGINEERS (ASCE) STANDARD 7-16 MINIMUM DESIGN LOADS FOR BUILDINGS AND OTHER STRUCTURES.
- WOOD WORK SHALL CONFORM TO THE NATIONAL DESIGN SPECIFICATION (NDS) 2018 EDITION.
- AMERICAN SOCIETY FOR TESTING AND MATERIALS, CURRENT EDITION

## DESIGN CRITERIA

WIND DESIGN: WIND LOAD IS BASED ON ASCE 7 CHAPTER 29 WITH THE FOLLOWING FACTORS

EXPOSURE CATEGORY = D      RISK CATEGORY = II  
 $V_{3s} = 98\text{MPH}$       WIND IMPORTANCE FACTOR,  $I_w = 1.0$

DESIGN VESSEL IS 30' LONG WITH AVERAGE FREEBOARD OF 11'-6"  
 DESIGN VESSEL IS 60' LONG WITH AVERAGE FREEBOARD OF 14'

WAVE LOADS:  $P = 328\text{ LBS}$

LIVE LOADS: LIVE LOAD = 40 PSF  
 SNOW LOAD = 25 PSF

SEISMIC LOADS: DOCK PILING  $R = 2.0$   
 SEISMIC IMPORTANCE = 1.0  
 $SD_1 = 0.595g$

## STRUCTURAL STEEL

- ALL MISCELLANEOUS STEEL SHAPES AND PLATES, EXCEPT AS NOTED BELOW, SHALL CONFORM TO ASTM 36.
- ALL WF SHAPES SHALL CONFORM TO ASTM A992,  $F_y = 50\text{ KSI}$
- ALL PILES SHALL CONFORM TO ASTM A252 GRADE 3,  $F_y = 45\text{ KSI}$
- ALL BOLTS SHALL BE ASTM A307, UNO.
- ALL NUTS SHALL BE ASTM A563, UNO.
- ALL WASHERS SHALL BE ASTM F436, UNO.
- ALL THREADED RODS SHALL CONFORM TO ASTM F1554, GRADE 36.
- ALL STEEL MEMBERS AND FASTENERS THAT ARE NOT EPOXY COATED SHALL BE HOT DIPPED GALVANIZED IN ACCORDANCE WITH ASTM A153 AS APPLICABLE.

## WELDING

- ALL WELDING SHALL BE PERFORMED BY WELDERS QUALIFIED FOR THE WELD AND POSITION SHOWN IN ACCORDANCE WITH AWS AND HAVING CURRENT CERTIFICATION FROM WABO.
- ALL WELDS SHALL BE PERFORMED WITH PROCEDURES PREQUALIFIED OR QUALIFIED IN ACCORDANCE WITH AWS D1.1.
- THE WELDS SHOWN ARE FOR THE FINAL CONNECTIONS, FIELD WELD SYMBOLS ARE SHOWN WHERE FIELD WELDS ARE REQUIRED BY THE STRUCTURAL DESIGN. THE CONTRACTOR IS RESPONSIBLE FOR DETERMINING IF A WELD SHOULD BE SHOP OR FIELD WELDED IN ORDER TO FACILITATE THE STRUCTURAL STEEL ERECTION.
- WELDING ELECTRODES SHALL BE 70 KSI STRENGTH AND SHALL BE "LOW-HYDROGEN ELECTRODES."

## WOOD

- EACH PIECE OF LUMBER SHALL BEAR A STAMP INDICATING A GRADE MARK OF THE WEST COAST LUMBER INSPECTION BUREAU (WCLIB), WESTERN WOOD PRODUCTS ASSOCIATION (WWPA), OR OTHER AGENCY ACCREDITED BY THE AMERICAN STANDARD COMMITTEE (ALSC).
- DIMENSION LUMBER SHALL BE P.T. DOUG-FIR NO 2 OR BETTER, UNLESS NOTED OTHERWISE.
- STRUCTURAL GLUED LAMINATED TIMBER SHALL BE ALASKAN CEDAR AC.AC 20F-V12.
- WOOD SHALL BE SEASONED DRY WITH A MAXIMUM MOISTURE CONTENT OF 19%.
- PRESERVATIVE TREATED WOOD SHALL CONFORM TO THE AMERICAN WOOD PROTECTION ASSOCIATION (AWPA) UC4A. ALL WOOD SHALL BEAR A TREATMENT IDENTIFICATION MARK BY THE CERTIFYING AGENCY.
- ALL BOLT HOLES IN WOOD MEMBERS SHALL BE A MINIMUM OF 1/32" TO MAXIMUM OF 1/16" LARGER THAN THE BOLT DIAMETER. PROVIDE PLATE WASHERS WHERE NUTS, BEAR ON WOOD. CUT WASHERS SHALL MEASURE 2 1/4"  $\phi$  x 3/16" THICK.

## GRATING

- DECK GRATING SHALL BE SUNWALK 90 SERIES OR APPROVED EQUAL.

## ABBREVIATIONS

@	AT
AWS	AMERICAN WELDING SOCIETY
CL	CENTER LINE
CLR	CLEAR
COL	COLUMN
CONT.	CONTINUOUS
DF	DOUG FIR
EA	EACH
EX OR (E)	EXISTING
GLB	GLULAM BEAM
LLH	LONG LEG HORIZONTAL
MIN	MINIMUM
MNFR	MANUFACTURER
OC	ON CENTER
OPP	OPPOSITE
PL	PLATE
PSI	POUNDS PER SQUARE INCH
PSF	POUNDS PER SQUARE FOOT
P.T.	PRESERVATIVE TREATED
SF	SQUARE FOOT
REF	REFERENCE
SIM	SIMILAR
SS	STAINLESS STEEL
t	THICK
TYP	TYPICAL
UNO	UNLESS NOTED OTHERWISE
VF	VERIFY IN FIELD
WABO	WASHINGTON ASSOCIATION OF BUILDING OFFICIALS
WF	WIDE FLANGE
W/	WITH



Seaborn Pile Driving  
 1080 W Ewing St  
 Seattle, WA 98119

Office: 206-236-1700 ext. 5  
[www.seabornpiledriving.com](http://www.seabornpiledriving.com)

Scope of Work: We propose to remove 289 sqft of the existing dock, remove the existing moorage cover, relocate the existing boat lift, repair 259 sqft of the existing dock, install 263 sqft of new dock, drive (12) new piles, remove (16) existing piles, repair (4) existing piles, and drive (1) new mooring pile.

County: King County  
 Location: Lake Washington

Applicant: Aqua Dock  
 6855 W. Mercer Way  
 Mercer Island, WA 98040

Datum: CORPS OF ENGINEERS 1919  
 SW Quarter Of Section 24, Township 14, Range 05

Adjacent Owners:  
 HAGSTROM COLIN S+JILLIAN J  
 7428 SE 71ST ST 98040

Last Updated: 12/9/2024 3:16 PM Kady

Created: 11/08/23

SHEET  
 11.0

# FRAMING PLAN

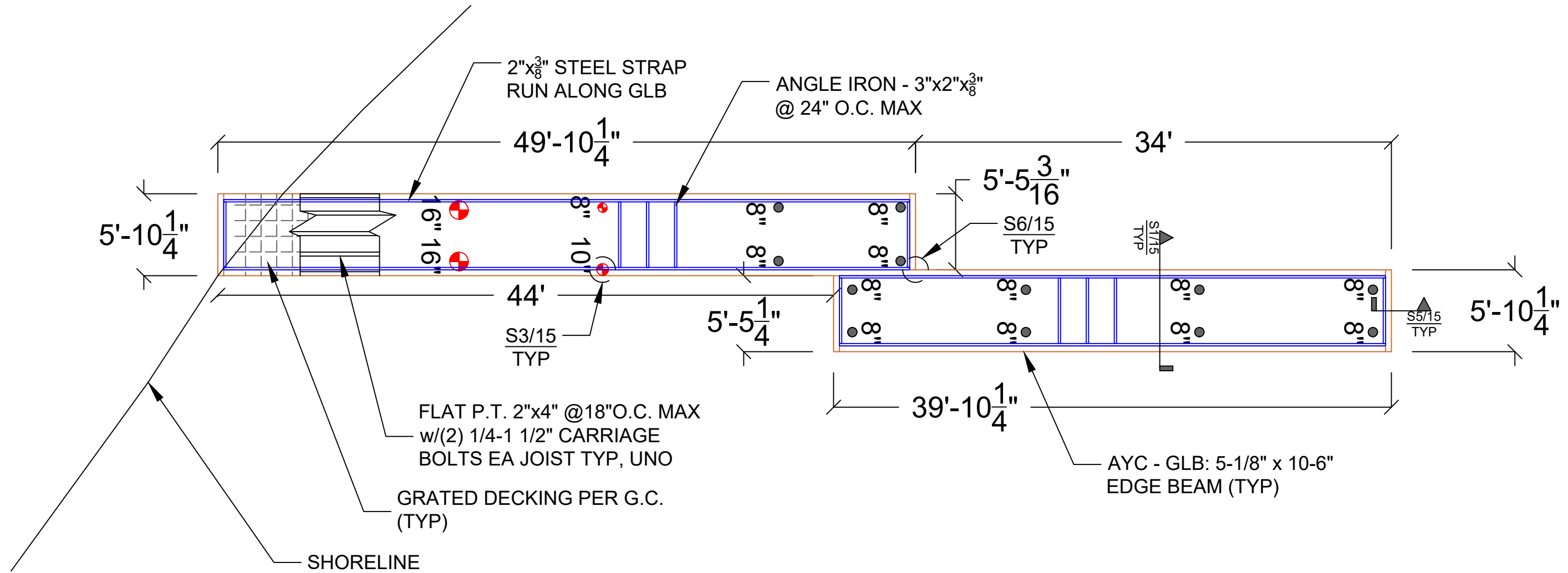

County: King County  
Location: Lake Washington

Applicant: Aqua Dock  
6855 W. Mercer Way  
Mercer Island, WA 98040

Datum: CORPS OF ENGINEERS 1919  
SW Quarter Of Section 24, Township 14, Range 05

Adjacent Owners:  
HAGSTROM COLIN S+JILLIAN J  
7428 SE 71ST ST 98040

WANG ZHUO+JUNE  
6839 W MERCER WAY

**SHEET**  
**12.0**

NWS-2023-XXX  
PAGE 12 OF 14



Seaborn Pile Driving  
1080 W Ewing St  
Seattle, WA 98119

Office: 206-236-1700 ext. 5  
www.seabornpiledriving.com

Scope of Work: We propose to remove 289 sqft of the existing dock, remove the existing moorage cover, relocate the existing boat lift, repair 259 sqft of the existing dock, install 263 sqft of new dock, drive (12) new piles, remove (16) existing piles, repair (4) existing piles, and drive (1) new mooring pile.

Last Updated: 12/9/2024 3:16 PM Kady

Created: 11/08/23

# DETAILS - TRACK

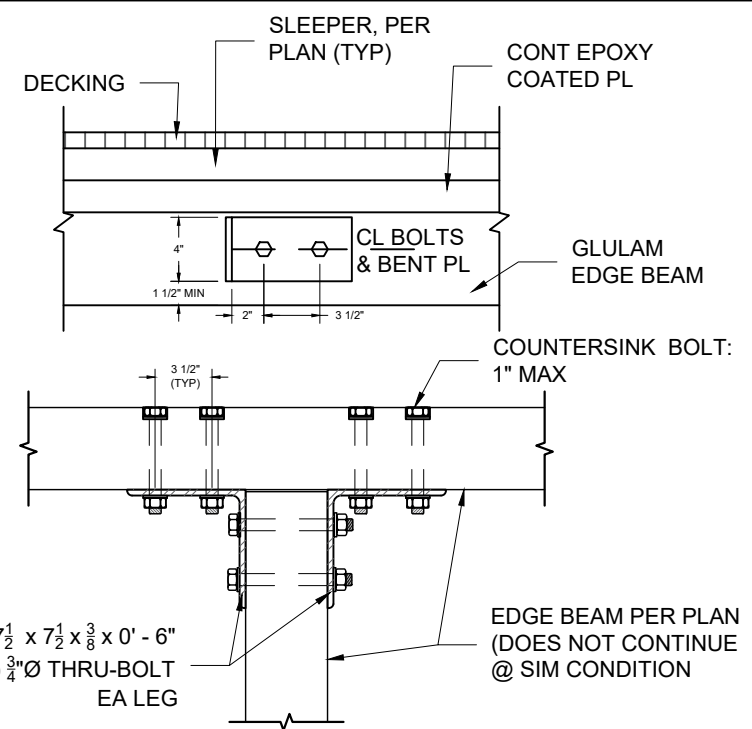
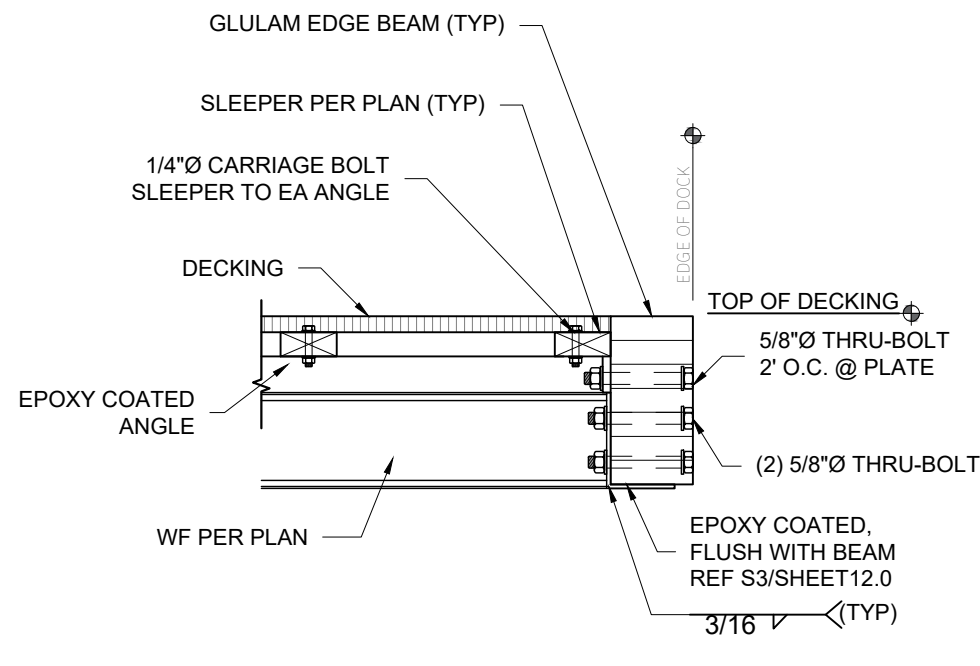
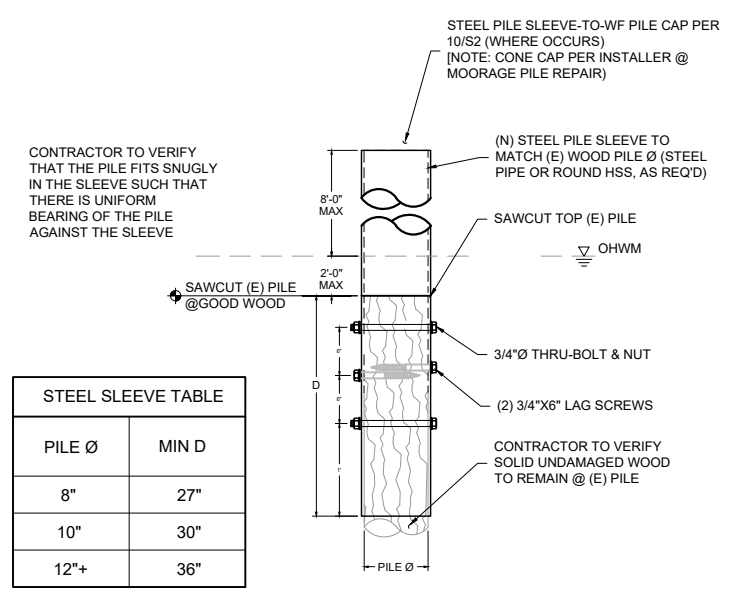
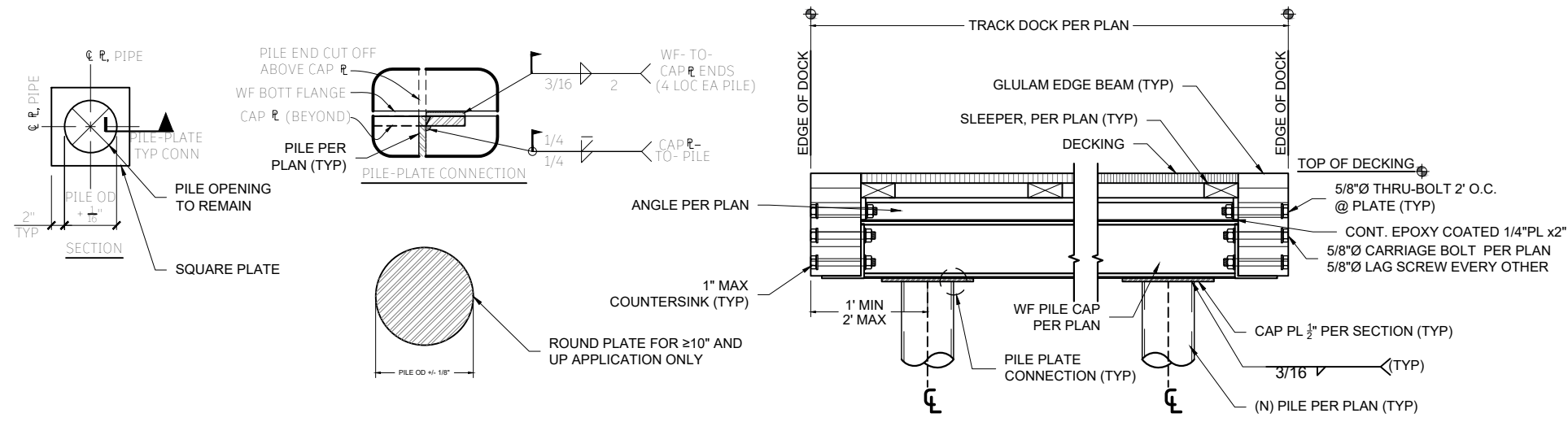

**S1 DOCK SECTION w/PILES - TYP**  
SCALE: 1" = 1'

**S3 SLEEVE PILE REPAIR - TYP**  
SCALE: 1/2" = 1'

**S4 DETAIL NOT IN USE**

**S5 EDGE SECTION (STEEL TRACK) - TYP**  
SCALE: 1" = 1'

**S6 BEAM TO BEAM - TYP**  
SCALE: 1" = 1'



Seaborn Pile Driving  
1080 W Ewing St  
Seattle, WA 98119  
Office: 206-236-1700 ext. 5  
www.seabornpiledriving.com

Scope of Work: We propose to remove 289 sqft of the existing dock, remove the existing moorage cover, relocate the existing boat lift, repair 259 sqft of the existing dock, install 263 sqft of new dock, drive (12) new piles, remove (16) existing piles, repair (4) existing piles, and drive (1) new mooring pile.

County: King County  
Location: Lake Washington

Applicant: Aqua Dock  
6855 W. Mercer Way  
Mercer Island, WA 98040

Datum: CORPS OF ENGINEERS 1919  
SW Quarter Of Section 24, Township 14, Range 05

Adjacent Owners:  
HAGSTROM COLIN S+JILLIAN J  
7428 SE 71ST ST 98040

WANG ZHUO+JUNE  
6839 W MERCER WAY

**SHEET 13.0**

# DETAILS - TRACK

S1 DETAIL NOT IN USE

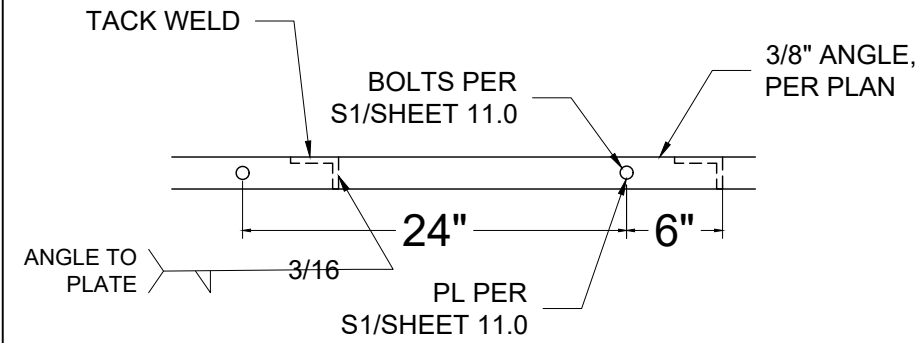

S2 ANGLE TO PLATE - TYP  
SCALE: 1" = 1"

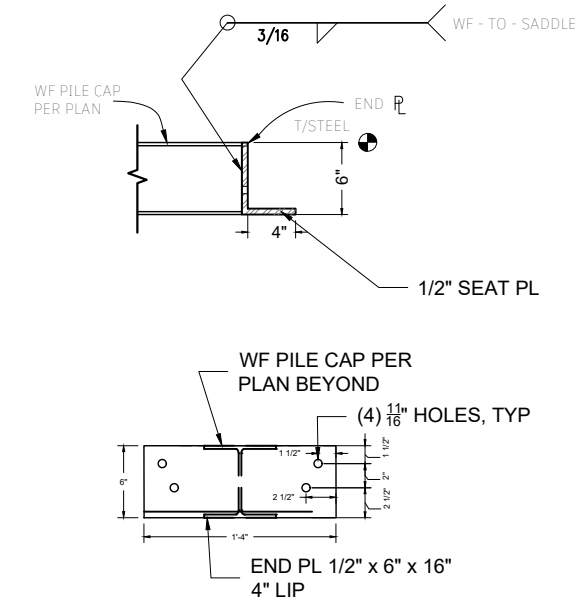

S3 BEAM SADDLE BRACKET  
SCALE: 3/4" = 1"

S4 DETAIL NOT IN USE

S5 DETAIL NOT IN USE

S6 DETAIL NOT IN USE



Seaborn Pile Driving  
1080 W Ewing St  
Seattle, WA 98119

Office: 206-236-1700 ext. 5  
www.seabornpiledriving.com

Scope of Work: We propose to remove 289 sqft of the existing dock, remove the existing moorage cover, relocate the existing boat lift, repair 259 sqft of the existing dock, install 263 sqft of new dock, drive (12) new piles, remove (16) existing piles, repair (4) existing piles, and drive (1) new mooring pile.

County: King County  
Location: Lake Washington

Applicant: Aqua Dock  
6855 W. Mercer Way  
Mercer Island, WA 98040

Datum: CORPS OF ENGINEERS 1919  
SW Quarter Of Section 24, Township 14, Range 05

Adjacent Owners:  
HAGSTROM COLIN S+JILLIAN J  
7428 SE 71ST ST 98040

Last Updated: 12/9/2024 3:16 PM Kady

Created: 11/08/23

**SHEET**  
**14.0**