

LANDSCAPE NOTES

1. ALL TECHNIQUES AND METHODS USED DURING CONSTRUCTION OF THE LANDSCAPE PORTION OF THIS PROJECT SHALL BE OF THE FIRST QUALITY AS COMPARED TO THE STANDARDS OF THE INDUSTRY. ALL ASPECTS OF THIS WORK WILL BE SUBJECT TO THE REVIEW AND APPROVAL OF THE LANDSCAPE ARCHITECT AND CITY OF MERCER ISLAND.
2. COORDINATE ALL WORK WITH OTHER CONTRACTORS ON SITE. THE LANDSCAPE CONTRACTOR SHALL OBTAIN ALL PERMITS NECESSARY FOR THAT PORTION OF THIS PROJECT.
3. THE CONTRACTOR SHALL BE RESPONSIBLE FOR DISPOSING OF ALL DEBRIS, RUBBISH AND AND EXCESS MATERIAL INCURRED BY THIS PROJECT.
4. DISCREPANCIES BETWEEN PLANS AND SITE CONDITIONS SHALL BE BROUGHT TO THE ATTENTION OF THE ARCHITECT PRIOR TO PROCEEDING.
5. VERIFY THE LOCATION OF ALL UTILITIES PRIOR TO PLAN INSTALLATION. NO TREES SHALL BE PLANTED CLOSER THAN 5 FEET TO UNDERGROUND UTILITIES IF AT ALL POSSIBLE.
6. VERIFY EXISTING GRADING IN FIELD PRIOR TO CONSTRUCTION. IF CONDITIONS ARE OTHER THAN EXPECTED, CONTACT THE ARCHITECT IMMEDIATELY.
7. EXISTING TOPSOIL SHOULD BE STRIPPED FROM CONSTRUCTION LOCATIONS, SAFELY STORED ON SITE, AND REUSED IN PLANTING BED PREPARATION. AUGMENT WHERE NECESSARY WITH "STERCO" PACIFIC TOPSOILS WINTERMIX OR AN APPROVED EQUIVALENT. TILL THOROUGHLY INTO PLANTING BEDS AND LAWN AREAS FOR A MINIMUM DEPTH OF 6 INCHES. REMOVE ROCKS AND DEBRIS LARGER THAN 1 INCH. SEE SOIL AMENDMENT NOTE BELOW.
8. COVER ALL TREE, SHRUB AND GROUND COVER PLANTING AREAS WITH A 3-INCH MINIMUM THICKNESS OF MULCH.
9. THE LANDSCAPE CONTRACTOR SHALL BE RESPONSIBLE FOR THE MAINTENANCE OF THE LANDSCAPE PORTION OF THIS PROJECT DURING CONSTRUCTION AND FOR A MINIMUM OF 30 DAYS AFTER FINAL ACCEPTANCE. THIS WORK SHALL TAKE THE FORM OF WATERING WHERE NECESSARY, DEBRIS PICKUP, WEEDING AND ANY PRUNING NEEDED TO KEEP THE LANDSCAPE IN FIRST CLASS CONDITION.
10. ALL PLANT MATERIAL SHALL BE IN GOOD GROWING CONDITION AT THE TIME OF PLANTING AND SHALL BE GUARANTEED FOR ONE FULL YEAR OR UNTIL THE NEXT GROWING SEASON (WHICHEVER TIME PERIOD IS LONGER) AFTER FINAL ACCEPTANCE. ANY REPLACEMENT PLANT MATERIAL REQUIRED SHALL BE EXACTLY THE SAME AS ORIGINALLY SPECIFIED AS TO TYPE AND SIZE. THE CONTRACTOR SHALL RE-DO ANY TREE STAKING AS IS APPROPRIATE DURING THIS TIME PERIOD.
11. DIG, PACK, TRANSPORT AND HANDLE ALL PLANTS WITH CARE TO ENSURE PROTECTION FROM INJURY. STORE PLANTS IN THE MANNER NECESSARY TO ACCOMMODATE THEIR HORTICULTURAL REQUIREMENTS. HEEL-IN PLANTS AND IRRIGATE AS NEEDED TO KEEP FROM DRYING OUT.
12. INSTALL APPROPRIATE TRANSPLANTER FERTILIZER TO ALL PLANTING PITS AS SPECIFIED BY MANUFACTURER.
13. STAKE ALL TREES AS SHOWN IN DETAIL.
14. THE CONTRACTOR IS RESPONSIBLE FOR WATERING ALL PLANTS TO ENSURE THEIR SURVIVAL UNTIL FINAL ACCEPTANCE AND/OR IRRIGATION SYSTEM HAS BEEN INSTALLED AND IS OPERATIONAL.

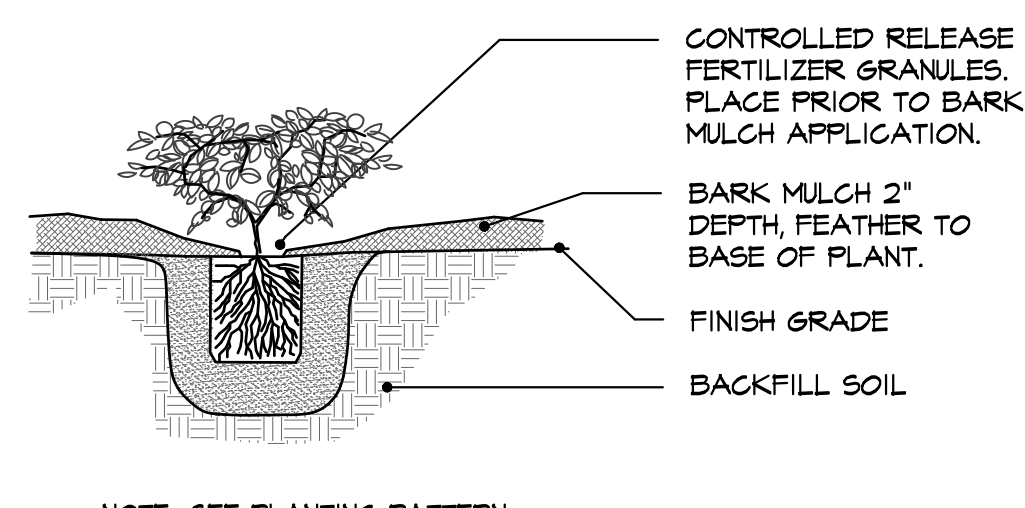

NOTE: SEE PLANTING PATTERN

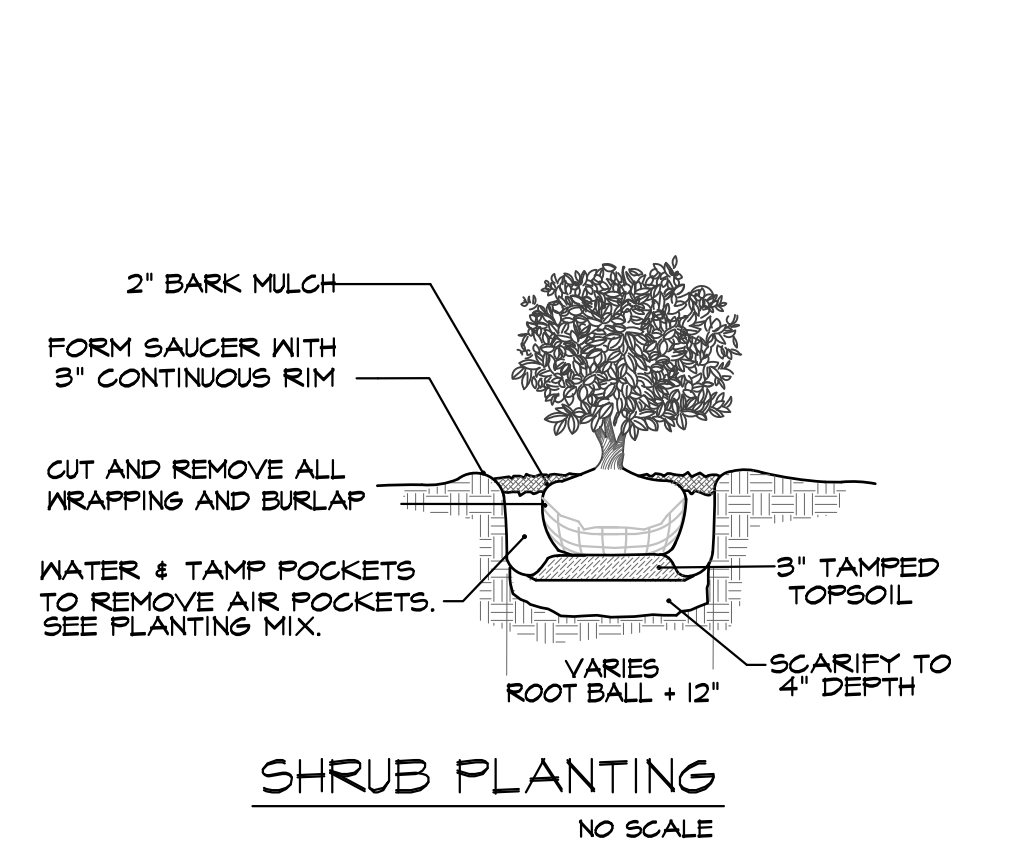
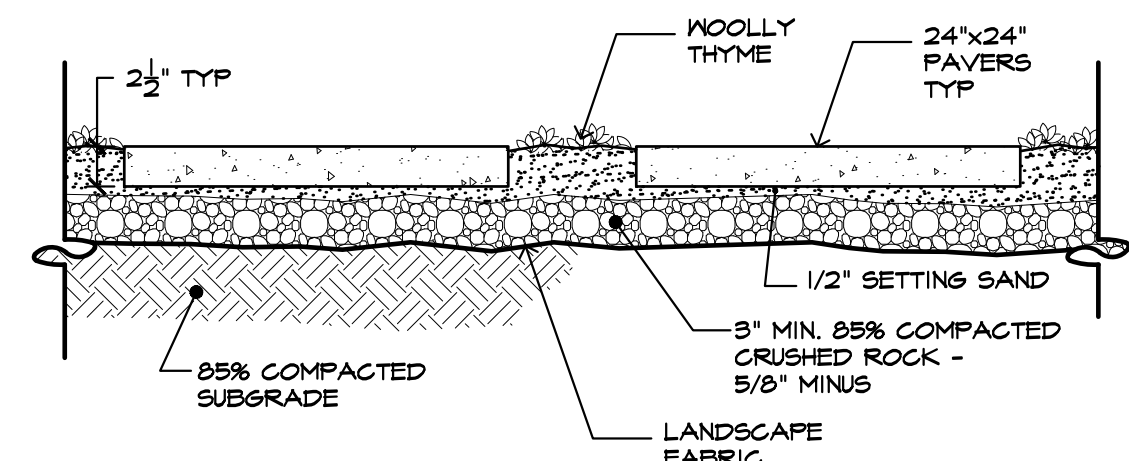

NOTE: IT IS RECOMMENDED THAT AN EDGE (PLASTIC, STEEL OR P.T. WOOD) BE INSTALLED ADJACENT TO THE PAVERS TO CONTAIN PLANTS AND CRUSHED ROCK IN THEIR PROPER LOCATIONS.

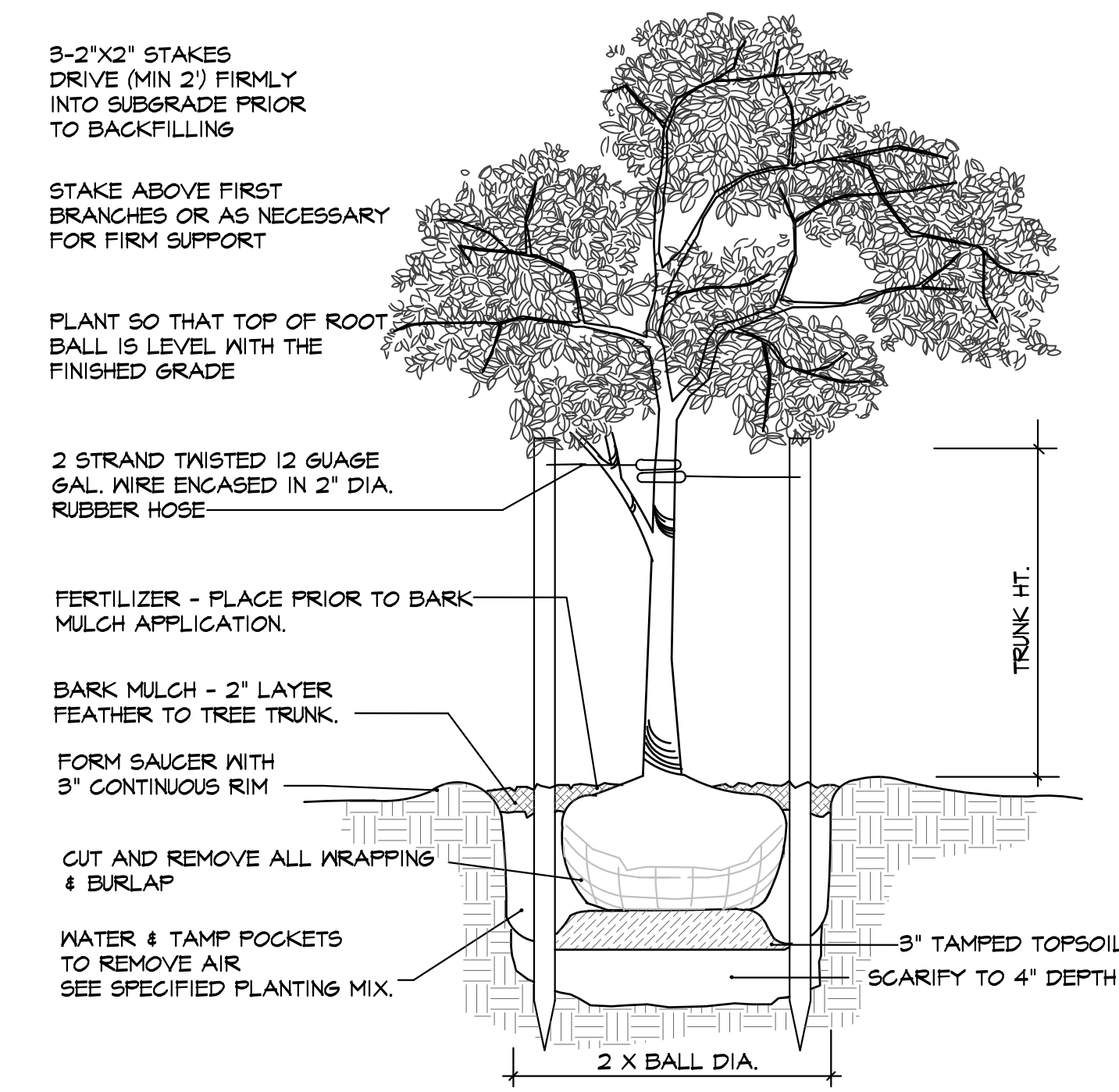
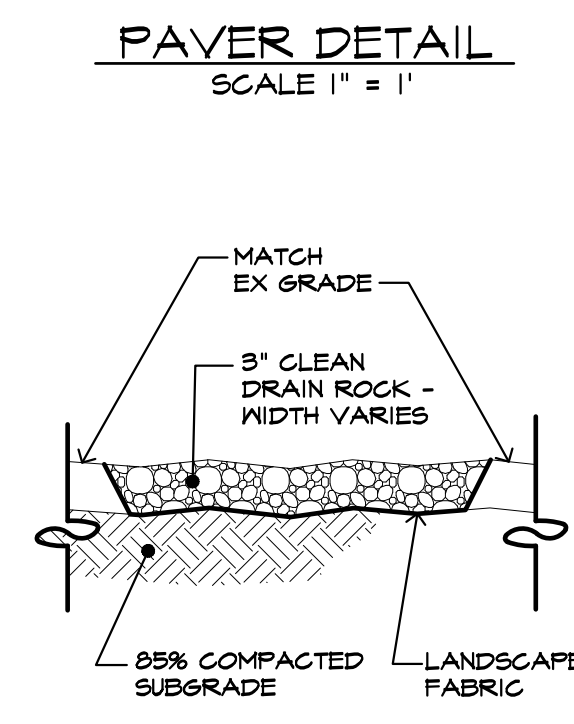

BY	CK	
NO.	DATE	REVISION
DESIGN GROUP	JOHN E. RUBENKOWIG, ASLA	
PROJECT MANAGER	JOHN E. RUBENKOWIG, ASLA	
DESIGNED	JOHN E. RUBENKOWIG, ASLA	
SRK		
CADD	JOHN E. RUBENKOWIG, ASLA	
CHECKED	JOHN E. RUBENKOWIG, ASLA	
DATE	02/08/2025	
FILE NAME	D0STUDIO.LSDWG	

LANDSCAPE NOTES & DETAILS

DAVID DO & KIM NGUYEN
4649 FOREST AVENUE SE
MERCER ISLAND, WA

WASHINGTON

KING COUNTY

RUBENKOWIG PLANNING AND LANDSCAPE ARCHITECTURE, PLLC
8218 210TH PLACE SW
EDMONDS, WA 98026
PH: (206) 497-9621

STATE OF WASHINGTON REGISTERED LANDSCAPE ARCHITECT

John E. Rubenwig

STAMP NOT VALID UNLESS SIGNED AND DATED

MARCH 24, 2025